

TRAFFIC CONTROL PLAN NOTES

- SEE SECTION 6F.03, SIGN PLACEMENT, OF THE STATE OF TENNESSEE MANUAL ON UNIFORM TRAFFIC CONTROL DEVICES (MUTCD) FOR INFORMATION ON PLACEMENT AND MOUNTING OF SIGNS.
- SIGNS SHOWN ON THIS PLAN ARE TO WARN TRAFFIC ABOUT THE CONSTRUCTION. OTHER TRAFFIC CONTROL DEVICES MAY BE REQUIRED DURING VARIOUS PHASES OF CONSTRUCTION.
- NOTHING IN THIS PLAN IS INTENDED TO SUPERSEDE OR RELIEVE THE CONTRACTOR OF THE RESPONSIBILITY OF INSTALLING THE APPROPRIATE TRAFFIC CONTROL DEVICES IN ACCORDANCE WITH THE CURRENT STATE OF TENNESSEE "MANUAL ON UNIFORM TRAFFIC CONTROL DEVICES FOR STREETS AND HIGHWAYS.
- CONTRACTOR SHALL BE REQUIRED TO NOTIFY THE CITY OF MEMPHIS CONSTRUCTION INSPECTION DEPARTMENT (636-2462) AND TRAFFIC ENGINEERING DEPARTMENT (576-6710) A MINIMUM OF 24 HOURS PRIOR TO COMMENCING CONSTRUCTION OR IMPLEMENTING A TRAFFIC CONTROL PLAN. ALL TRAFFIC CONTROL DEVICES MUST BE IN PLACE BEFORE CONSTRUCTION ACTIVITY BEGINS.
- SIZES OF ALL SIGNS SHALL COMPLY WITH STATE OF TENNESSEE MANUAL ON UNIFORM TRAFFIC CONTROL DEVICES (MUTCD).
- ALL TRAFFIC CONTROL DEVICES AND THEIR INSTALLATION SHALL MEET THE STANDARD PRESCRIBED IN THE STATE OF TENNESSEE MANUAL ON UNIFORM TRAFFIC CONTROL DEVICES AND SHALL COMPLY WITH THE STATE OF TENNESSEE STANDARD SPECIFICATIONS FOR ROAD AND BRIDGE CONSTRUCTION SECTION 712 TEMPORARY TRAFFIC CONTROL.
- ACCESS TO ADJACENT PROPERTIES SHALL BE MAINTAINED AT ALL TIMES.
- SIDE STREET, DRIVEWAY ACCESS, AND SAFE PEDESTRIAN WAYS SHALL BE MAINTAINED AT ALL TIMES. CONTRACTOR MUST USE PUBLIC RIGHTS-OF-WAY ACCESSIBILITY GUIDELINES (PROWAG) AND INCLUDE ALTERNATE PEDESTRIAN ACCESS ROUTES FROM THE MANUAL UNIFORM TRAFFIC CONTROL DEVICES (MUTCD) SECTIONS 6D.01, 6D.02, AND 6G.05 AND PEDESTRIAN BARRICADES AND CHANNELING DEVICES FROM THE MUTCD SECTIONS 6F.63, 6F.68, AND 6F.71.
- THE CONTRACTOR SHALL NOT BE PERMITTED TO PARK ANY VEHICLES OR CONSTRUCTION EQUIPMENT DURING PERIODS OF INACTIVITY, WITHIN THE RIGHT-OF-WAY OR WITHIN THIRTY (30) FEET OF THE EDGE OF PAVEMENT WHICHEVER IS LESS, WHEN THE LANE IS OPEN TO TRAFFIC, UNLESS PROTECTED BY GUARDRAIL, BRIDGE RAIL, AND/OR BARRIERS INSTALLED FOR OTHER PURPOSES. PRIVATELY OWNED VEHICLES SHALL NOT BE ALLOWED TO BE PARKED WITHIN THE RIGHT-OF-WAY OR WITHIN THIRTY (30) FEET OF AN OPEN TRAFFIC LANE WHICHEVER IS LESS, AT ANY TIME UNLESS PROTECTED AS DESCRIBED ABOVE.
- CONTRACTOR SHALL USE PLASTIC DRUMS WITH TYPE "C" WARNING LIGHTS TO SEPARATE TRAFFIC FROM THE CONSTRUCTION AREA.
- CONTRACTOR SHALL COVER ALL EXISTING SIGNS THAT CONFLICT WITH THE TRAFFIC CONTROL PLAN SIGNS OR DEVICES DURING CONSTRUCTION AND THEY SHALL REMAIN COVERED DURING CONSTRUCTION AND UNTIL SUCH TIME THAT NO CONFLICT EXISTS.
- ALL TEMPORARY OR PERMANENT TRAVELED SURFACE SHALL BE INSPECTED DAILY BY THE CONTRACTOR (INCLUDING WEEKENDS) AND NECESSARY PATCHING OR RE-FINISHING PERFORMED.
- WORK WITHIN THE ROADWAY SHALL BE CONDUCTED BETWEEN 9:00 A.M. AND 4:00 P.M. AND THE ROADWAY SHALL BE COMPLETELY OPEN TO TRAFFIC AT ALL OTHER TIMES AND ALL INAPPROPRIATE SIGNS SHALL BE COVERED OR REMOVED.
- CONTRACTOR SHALL CONTACT THE CITY OF MEMPHIS SIGNAL SHOP AT 528-2844 FOR LOCATION OF SIGNAL CONDUIT AND WIRES.
- IF CONSTRUCTION ACTIVITIES REQUIRE OVER-NIGHT CLOSURE OF ANY PORTION OF THE ROADWAY, A REVISED TRAFFIC CONTROL PLAN SHALL BE SUBMITTED TO AND APPROVED BY THE CITY ENGINEER'S OFFICE.
- EXISTING STRIPING THAT CONFLICTS WITH THE TEMPORARY TRAFFIC CONTROL DEVICES SHALL BE COVERED OR REMOVED DURING CONSTRUCTION. WHEN CONSTRUCTION IS COMPLETE THE EXISTING STRIPING SHALL BE RETURNED TO ITS ORIGINAL STATE.
- ALL TRAFFIC CONTROL SIGNS SHALL MEET THE MINIMUM RETROREFLECTIVITY LEVELS SPECIFIED IN THE CURRENT EDITION OF THE MANUAL ON UNIFORM TRAFFIC CONTROL DEVICES (MUTCD).
- THE CONTRACTOR IS PROHIBITED FROM CLOSING THE EXISTING SIDEWALK AT ANYTIME DURING THIS PROJECT. IF A SIDEWALK CLOSURE IS NEEDED, A REVISED TRAFFIC CONTROL PLAN SHALL BE SUBMITTED TO AND APPROVED BY THE CITY ENGINEER'S OFFICE. CONTRACTOR MUST USE PUBLIC RIGHTS-OF-WAY ACCESSIBILITY GUIDELINES (PROWAG) AND INCLUDE ALTERNATE PEDESTRIAN ACCESS ROUTES FROM THE MANUAL UNIFORM TRAFFIC CONTROL DEVICES (MUTCD) SECTIONS 6D.01, 6D.02, AND 6G.05 AND PEDESTRIAN BARRICADES AND CHANNELING DEVICES FROM THE MUTCD SECTIONS 6F.63, 6F.68, AND 6F.71.
- ANY CLOSURE OF THE RIGHT OF WAY SHALL BE TIME LIMITED TO THE ACTIVE DEMOLITION OR CONSTRUCTION. CONTINUOUS UNWARRANTED CLOSURE OF THE RIGHT OF WAY SHALL NOT BE ALLOWED FOR THE DURATION OF THE PROJECT. THE DEVELOPER SHALL PROVIDE ON THE TRAFFIC CONTROL PLAN, THE TIME NEEDED PER PHASE TO COMPLETE THAT PORTION OF THE WORK. TIME LIMITS WILL BEGIN ON THE DAY OF CLOSURE AND WILL BE MONITORED BY THE ENGINEERING CONSTRUCTION INSPECTORS (636-2462) ON THE JOB.

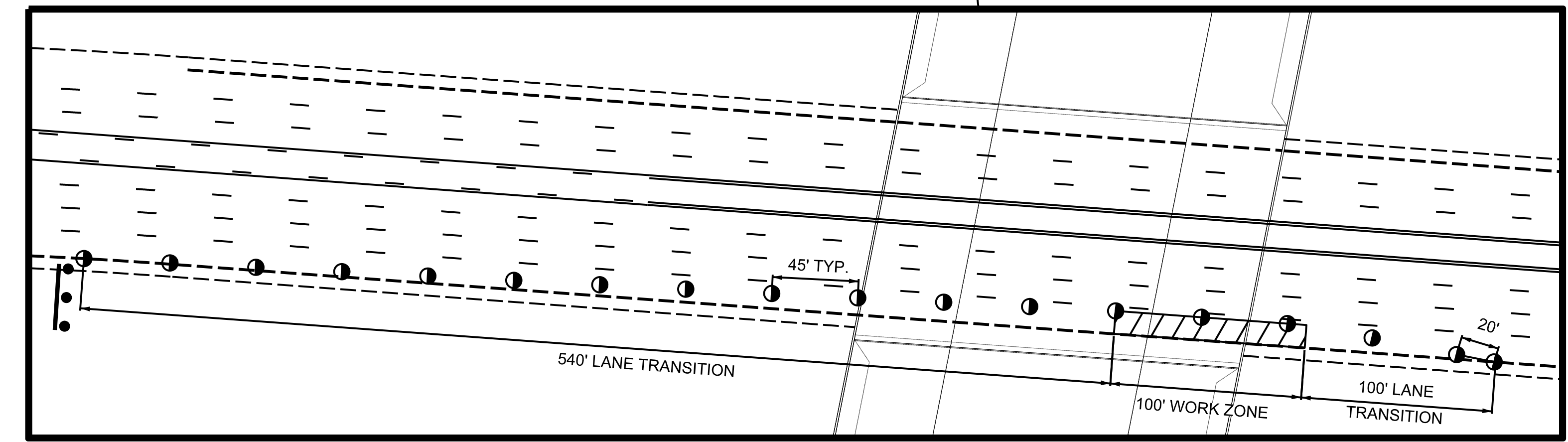

WINCHESTER TRAFFIC CONTROL
SCALE = 1"=50'

TRAFFIC CONTROL LEGEND	
SYMBOL	ITEM
	SIGN (CONSTRUCTION)
	FLEXIBLE DRUMS (CHANNELIZING)
	WORK ZONE
	FLASHING YELLOW BOARD

REVISION		
ITEM NO.	DESCRIPTION OF CHANGE	APPROVAL DATE
ELECTRICAL DAMAGE REPAIR		
DEVELOPER: CITY OF MEMPHIS ENGINEER: BARGE DESIGN SOLUTIONS		

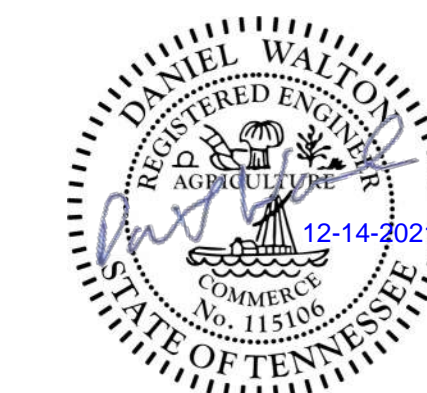

SHEET TC-01

DIVISION OF ENGINEERING
**WINCHESTER TAXIWAY YANKEE BRIDGE
TRAFFIC CONTROL PLANS
MEMPHIS, TN**

SURVEY BY: _____ DATE: _____ BOOK: _____
 DESIGN BY: BARGE DATE: _____ SCALE: 1"=100'
 APPROVED _____
 CITY TRAFFIC ENGINEER DATE CITY ENGINEER DATE