

PROJECT PHASING PLAN

SCHEDULE A: RAMP RECONSTRUCTION (AREA 2)

PHASE ONE: (15 CALENDAR DAYS)
MOBILIZATION, INSTALL PHASE 1 BARRICADES, PERFORM RECONSTRUCTION IN PHASE 1 AREA.

PHASE TWO: (15 CALENDAR DAYS)
RE-OPEN PHASE 1 AREA, INSTALL PHASE 2 BARRICADES, PERFORM RECONSTRUCTION IN PHASE 2 AREA, REMOVE BARRICADES, DEMOBILIZE.

SCHEDULE B: PARKING LOT RECONSTRUCTION

PHASE ONE: (30 CALENDAR DAYS)
MOBILIZATION, PERFORM RECONSTRUCTION (PHASING REQUIRED TO MAINTAIN ACCESS THROUGH AT LEAST ONE VEHICLE GATE AT ALL TIMES), DEMOBILIZE.

NOTE:
THE EXISTING AIRPORT PAVEMENTS ARE DESIGNED FOR AIRCRAFT TRAFFIC ONLY, AND MAY NOT SUPPORT LOADED TRUCKS OR HEAVY EQUIPMENT. ANY DAMAGE RESULTING FROM THE CONTRACTOR'S ACTIONS WILL BE IMMEDIATELY REPAIRED TO FAA STANDARDS AT THE CONTRACTOR'S EXPENSE.

THE CONTRACTOR IS ENCOURAGED TO DOCUMENT VIA PICTURES AND/OR VIDEO THE PRE-CONSTRUCTION CONDITION OF ALL PAVEMENTS AND STRUCTURES. ANY DAMAGE NOTICED AFTER THE CONTRACTOR'S MOBILIZATION WILL BE ASSUMED TO BE CAUSED BY THE CONTRACTOR AND SHALL BE FULLY REPAIRED AT THE CONTRACTOR'S EXPENSE.

811 Know what's below Call before you dig.
811
www.call811.com

LOCAL EMERGENCY PHONE NUMBERS
EMERGENCY: 911
MILLINGTON POLICE DEPT: (901) 872-3333
FIRE DEPARTMENT: (901) 873-5800
AIRPORT: (901) 358-0028
MEDICAL: (901) 516-5200

UTILITY CONTACTS
MLGW: (901) 528-4270

LIQUIDATED DAMAGES
\$2,000 PER CALENDAR DAY

CONTRACT TIME
SCHEDULE A: 30 CALENDAR DAYS
SCHEDULE B: 30 CALENDAR DAYS
TOTAL ALL SCHEDULES: 60 CALENDAR DAYS

REVISIONS			
NO.	DATE	BY	REMARKS
1	5-30-85	L.R.H.	REMOVED DIV. OF PUBLIC WORKS (T.BLK.)
2	2-3-88	D.H.G.	REMOVED DEPARTMENT (T.BLK.)

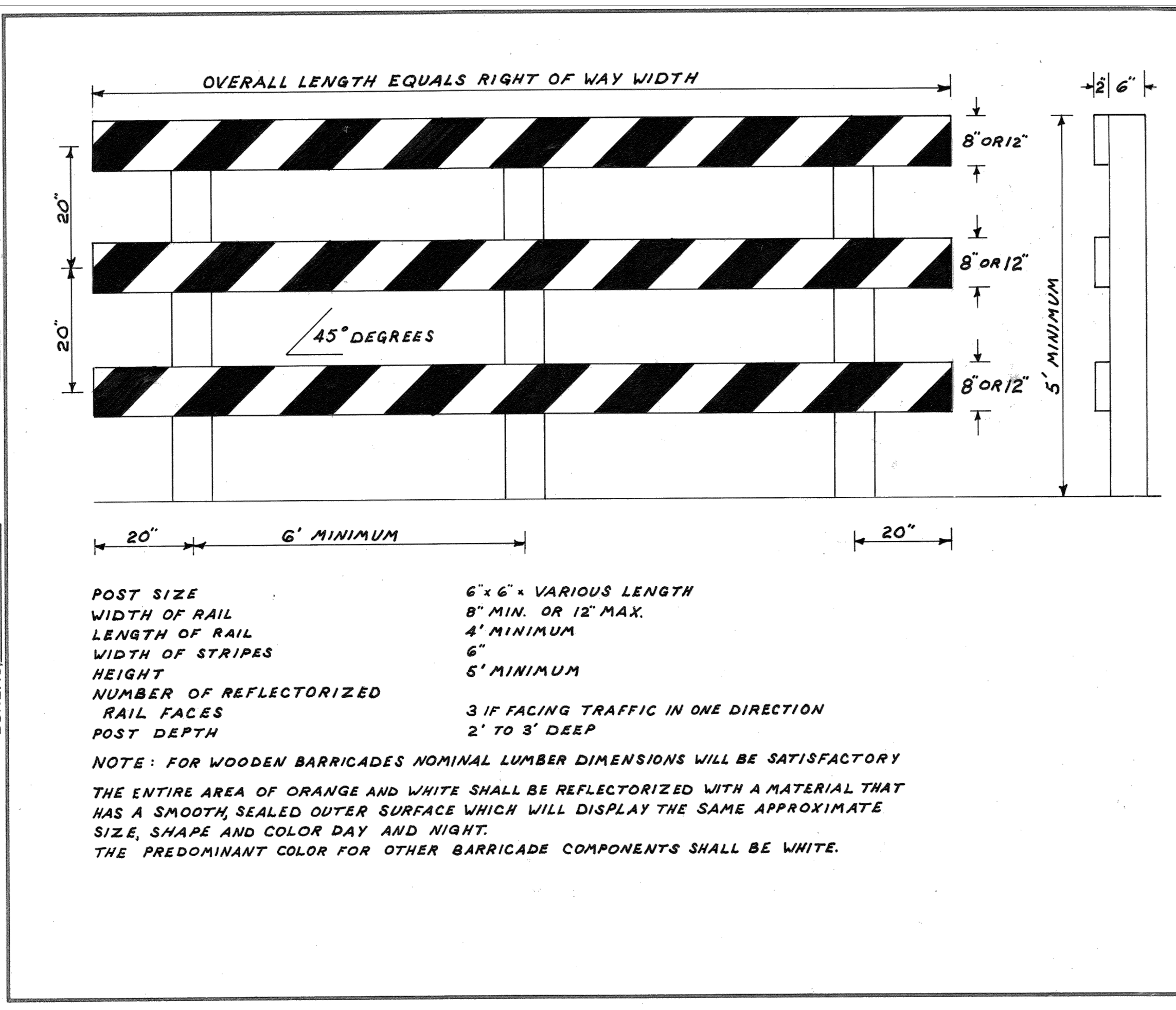

CITY OF MEMPHIS
DIVISION OF ENGINEERING

DESIGN STANDARD
FOR
TYPE III BARRICADE
FIXED TYPE

J. J. Jamary 2-9-81
DEPUTY DIRECTOR, CIVIL ENGINEER DATE

DWG. NO. 35

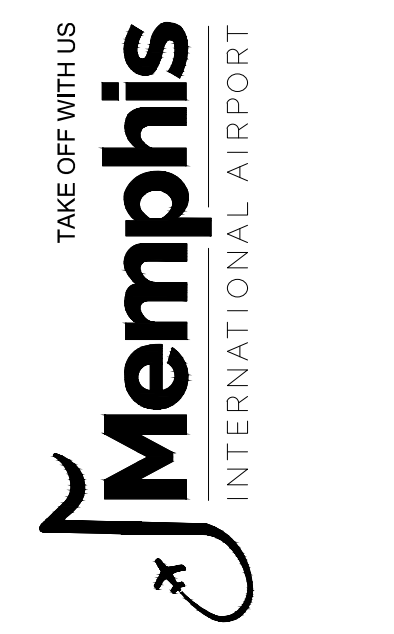
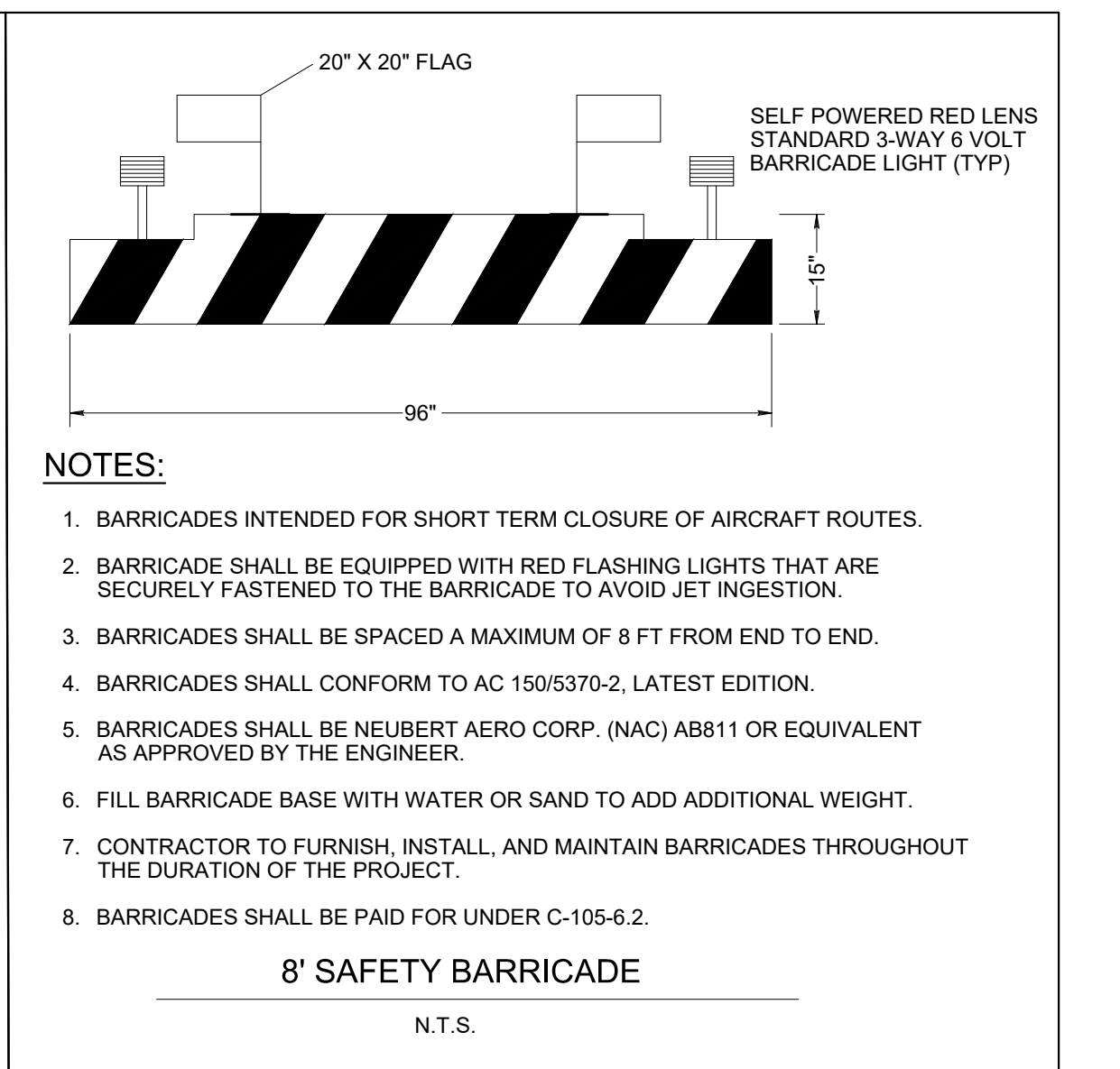
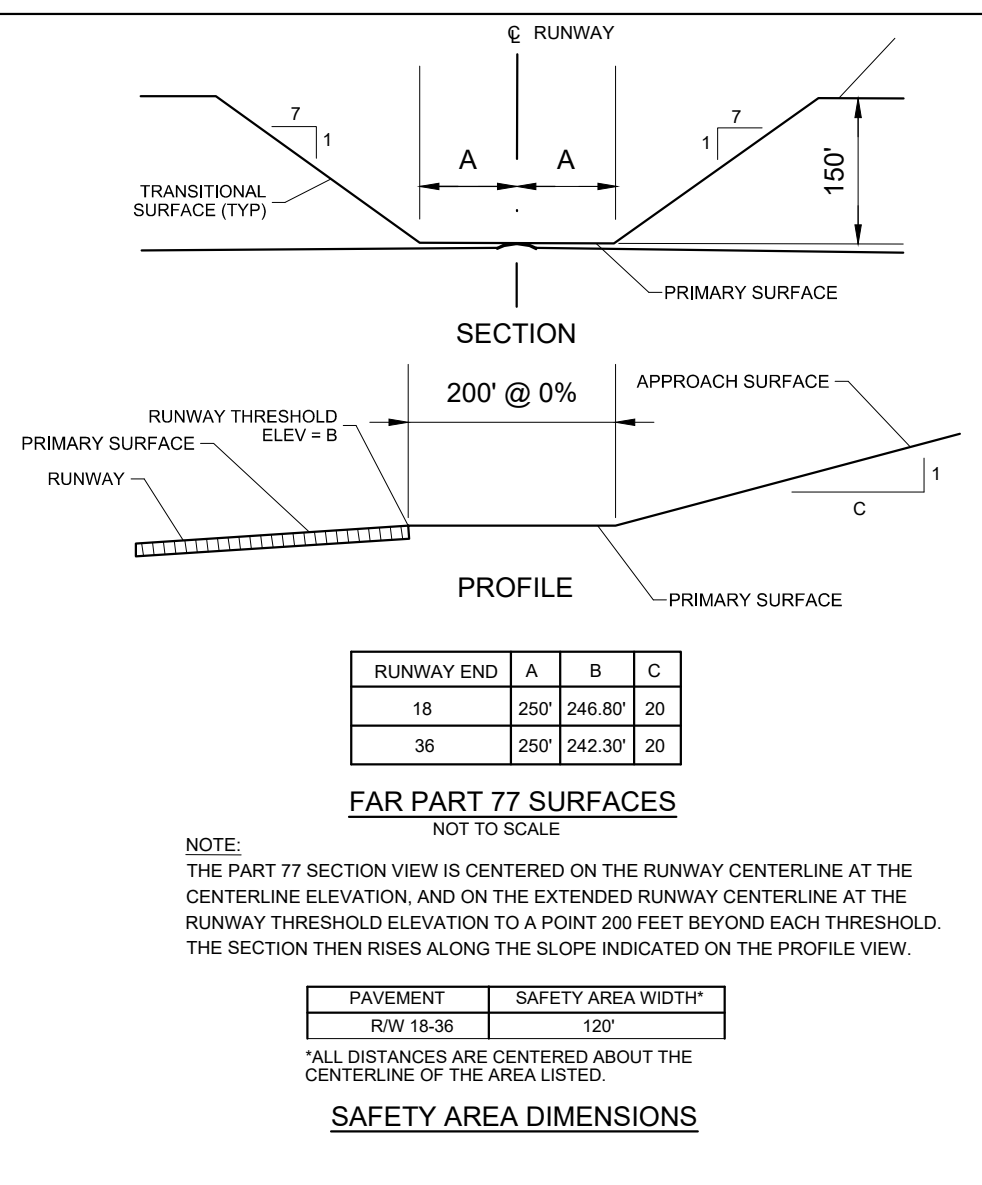

PROGRAM MANAGER

ENGINEER

BARGE
DESIGN SOLUTIONS, INC.
65 GERMANTOWN CT, SUITE 100
MEMPHIS, TN 38018

JOB NO. 33276-02

DRAWN BY: JEM

CHECKED BY: JAN

APPROVED BY: JEG

STATE OF TENNESSEE
REGISTERED ENGINEER
JAMES E. MALONE
No. 11871
COMMERCE

This information is released solely for its use in the interest of the Memphis-Shelby County Airport Authority (MSCAA) or its Tenants. All drawings received from MSCAA or produced for MSCAA as a work product shall be regarded as privileged information, not to be released to others without the express written permission of MSCAA. Your acceptance of the released materials establishes your understanding of, and commitment to, providing adequate control of the materials issued and produced.

REVISIONS		
MARK	DATE	DESCRIPTION
	4/7/26	ISSUED FOR BID
Δ	4/28/26	ADDENDUM #1

MSCAA PROJ. NO. 18-1420-02-01

PROJECT: CHARLES BAKER PAVEMENT IMPROVEMENTS PHASE 2 - CONSTRUCTION

SHEET TITLE: CONSTRUCTION SAFETY & PHASING PLAN

DWG. FILE NAME: 3327602-12C-SF-01.DWG

DATE: 4/7/26 SHEET NO. C-SF-01

SCALE: 1"=200' SHEET 3A OF 23

SUMMARY OF QUANTITIES

BASE BID: AREA 2				
ITEM	DESCRIPTION	QUANTITY	UNIT	
1	C-100-14.1	CONTRACTOR QUALITY CONTROL PROGRAM (CQCP)	1	LS
2	C-102-5.1	EROSION CONTROL SILT FENCE (INSTALLATION & REMOVAL)	170	LF
3	C-102-5.2	WEIGHTED WATTLES (INSTALLATION & REMOVAL)	430	LF
4	C-105-6.1	MOBILIZATION	1	LS
5	C-105-6.2	AIRFIELD BARRICADES	1	LS
6	P-101-5.1	SAW-CUT ASPHALT	980	LF
7	P-101-5.2	TIE DOWN REMOVAL	10	EA
8	P-151-4.1	CLEARING AND GRUBBING	0.40	AC
9	P-152-4.1	UNCLASSIFIED EXCAVATION (INCLUDES STRIPPING & REPLACING TOPSOIL)	100	CY
10	P-207-5.1	IN-PLACE FULL DEPTH RECYCLED (FDR) ASPHALT AGGREGATE BASE COURSE	5,730	SY
11	P-209-5.1	COARSE AGGREGATE BASE COURSE (6" COMPACTED THICKNESS)	125	SY
12	P-403-8.1	ASPHALT SURFACE COURSE (1.5" COMPACTED THICKNESS)	552	TONS
13	P-403-8.2	ASPHALT BINDER COURSE (2.5" COMPACTED THICKNESS)	867	TONS
14	P-501-8.1	CEMENT CONCRETE PAVEMENT (6" THICKNESS)	125	SY
15	P-602-5.1	EMULSIFIED ASPHALT PRIME COAT	1,719	GAL
16	P-603-5.1	EMULSIFIED ASPHALT TACK COAT	573	GAL
17	P-610-6.1	AIRCRAFT TIE-DOWNS	6	EA
18	P-620-5.1	PAVEMENT MARKING, REFLECTIVE YELLOW	350	SF
19	P-620-5.2	PAVEMENT MARKING, NON-REFLECTIVE WHITE	186	SF
20	T-904-5.1	SODDING	35	SY
BASE BID: TERMINAL PARKING LOT				
ITEM	DESCRIPTION	QUANTITY	UNIT	
21	C-102-5.1	EROSION CONTROL SILT FENCE (INSTALLATION & REMOVAL)	560	LF
22	C-102-5.2	WEIGHTED WATTLES (INSTALLATION & REMOVAL)	31	LF
23	C-105-6.1	MOBILIZATION	1	LS
24	C-105-6.3	TYPE 3 TRAFFIC BARRICADES	1	LS
25	P-101-5.1	SAW-CUT ASPHALT	60	LF
26	P-152-4.1	UNCLASSIFIED EXCAVATION (INCLUDES STRIPPING & REPLACING TOPSOIL)	900	CY
27	P-207-5.1	IN-PLACE FULL DEPTH RECYCLED (FDR) ASPHALT AGGREGATE BASE COURSE	4,100	SY
28	TDOT-411D-3.1	ASPHALTIC CONCRETE SURFACE (HOT MIX) (1.5" COMPACTED THICKNESS)	395	TONS
29	TDOT-307-3.1	BITUMINOUS PLANT MIX BASE (HOT MIX) (2.5" COMPACTED THICKNESS)	620	TONS
30	TDOT-402-3.1	BITUMINOUS MATERIAL FOR PRIME COAT	1,230	GAL
31	TDOT-403-3.1	BITUMINOUS MATERIAL FOR TACK COAT	410	GAL
32	TDOT-501-3.1	CEMENT CONCRETE PAVEMENT (6" THICKNESS)	200	SY
33	TDOT-702-3.1	CURB & GUTTER	126	LF
34	P-620-5.3	PAVEMENT MARKING, NON-REFLECTIVE YELLOW	730	SF
35	T-904-5.1	SODDING	189	SY
36	PLANS	INSTALL TWO (2) CONCRETE DUMPSTER PADS & AND ENCLOSURES W/ DUMPSTERS	1	LS
37	SECURITY ALLOWANCE	AT EACH VEHICLE GATE ENTRY AND ONE (1) AT THE WEST END OF PARKING LOT. TWO (2) NEW ACCESS CONTROL DEVICES AT VEHICLE ENTRY GATE AND TWO (2) NEW PARKING LOT LIGHT POLES TO INCLUDE FULL CUTOFF LED LIGHTS SHALL BE INSTALLED	1	LS
38	FLAGPOLE ALLOWANCE	REMOVE THE EXISTING FLAGPOLE ON THE EAST SIDE OF THE TERMINAL AND INSTALL A NEW POLE LOCATED AT THE SOUTHWEST GRASSED AREA OF THE NEW TERMINAL	1	LS

GENERAL NOTES:

- THE CONTRACTOR MUST SCHEDULE OPERATIONS IN ORDER TO COMPLETE CONSTRUCTION IN THE OVERALL TIME LIMIT SPECIFIED. CONTRACTOR IS TO PREPARE A CONSTRUCTION SCHEDULE TO INCLUDE THE PROPOSED SEQUENCE OF CONSTRUCTION, AND BRING THE SCHEDULE TO THE PRECONSTRUCTION MEETING FOR REVIEW AND APPROVAL.
- THE CONTRACTOR SHALL COMPLY WITH ALL PERTINENT PROVISIONS OF THE "MANUAL OF ACCIDENT PREVENTION IN CONSTRUCTION" ISSUED BY AGC OF AMERICA, INC. AND THE "SAFETY AND HEALTH REGULATIONS FOR CONSTRUCTION" ISSUED BY THE UNITED STATES DEPARTMENT OF LABOR. REFER TO MSCAA SAFETY MANUAL FOR ADDITIONAL SAFETY REQUIREMENTS.
- THE LOCATIONS OF UTILITIES (INCLUSIVE OF STORM DRAINS) SHOWN WITHIN THESE PLANS ARE APPROXIMATE. EXACT LOCATIONS SHALL BE VERIFIED IN THE FIELD BY THE CONTRACTOR PRIOR TO CONSTRUCTION. CONTRACTOR SHALL CALL TENNESSEE ONE CALL AT 1-800-351-1111 (OR 811). CONTRACTOR SHALL ALSO CONTACT THE AIRPORT FOR UTILITY LOCATIONS.
- CONTRACTOR SHALL GIVE ALL NECESSARY NOTICES AND OBTAIN ALL PERMITS.
- PROPOSED HAUL ROUTES AND STOCKPILE AREAS SHALL BE APPROVED BY THE RESIDENT PROJECT REPRESENTATIVE AND THE OWNER PRIOR TO START OF WORK. ALL CONSTRUCTION TRAFFIC MUST ENTER AND EXIT THE PROJECT WORK AREA PER DESIGNATED HAUL ROUTES.
- CONTRACTOR SHALL REVIEW PROJECT CONSTRUCTION SAFETY PLAN AND BE FAMILIAR WITH ALL AIRPORT OPERATIONAL SAFETY AREAS. NO EQUIPMENT SHALL BE LEFT IN THE RUNWAY/TAXIWAY SAFETY/OBJECT FREE AREAS, AND LIGHTED BARRICADES SHALL BE PROVIDED AS REQUIRED.
- GENERAL CONTRACTOR SHALL HAVE AN AUTHORIZED JOB SUPERINTENDENT ON SITE WHENEVER WORK IS BEING PERFORMED BY ANY TRADE.
- CONTRACTOR IS REQUIRED TO FURNISH ALL STAKING REQUIRED FOR COMPLETION OF THE JOB. HORIZONTAL AND VERTICAL CONTROL ARE TO BE ESTABLISHED BY THE ENGINEER.
- IN THE EVENT OF ANY DISCREPANCIES AND/OR ERRORS FOUND IN THE DRAWINGS, OR IF PROBLEMS ARE ENCOUNTERED DURING CONSTRUCTION, THE CONTRACTOR SHALL BE REQUIRED TO NOTIFY THE ENGINEER BEFORE PROCEEDING WITH THE WORK. IF ENGINEER IS NOT NOTIFIED, THE CONTRACTOR SHALL TAKE RESPONSIBILITY FOR THE COST OF ANY REVISIONS.
- THE CONTRACTOR SHALL BE RESPONSIBLE FOR THE STABILIZATION OF AND THE MAINTENANCE OF ALL ACCESS AND HAUL ROUTES. ALL ACCESS AND HAUL ROUTES SHALL BE RETURNED TO THEIR ORIGINAL CONDITION, OR LEFT AS DESIRED BY THE OWNER, PRIOR TO FINAL ACCEPTANCE OF THE PROJECT.
- THE CONTRACTOR SHALL BE RESPONSIBLE FOR REPAIRING ANY EXISTING PAVEMENTS, ON OR OFF THE AIRPORT PROPERTY, WHICH BECOME DAMAGED BY CONSTRUCTION TRAFFIC.
- THESE NOTES ARE INTENDED TO SUPPLEMENT PROJECT SPECIFICATIONS AND IN NO WAY INVALIDATE SPECIFICATIONS PROVIDED IN OTHER BID DOCUMENTS (GENERAL OR SPECIFIC REQUIREMENTS).
- SURPLUS MATERIAL NOT RETAINED BY THE AIRPORT AND NOT REQUIRED FOR SITE CONSTRUCTION SHALL BE DISPOSED OF BY THE CONTRACTOR AT THE CONTRACTOR'S EXPENSE.
- COORDINATE ALL WORK WITH THE RPR. RPR WILL COORDINATE WITH AIRPORT MANAGER FOR APPROVAL.



PROGRAM MANAGER

ENGINEER



BARGE DESIGN SOLUTIONS, INC.
65 GERMANTOWN CT, SUITE 100
MEMPHIS, TN 38018

JOB NO. **33276-02**

DRAWN BY:

JEM

CHECKED BY:

JAN

APPROVED BY:

JEG

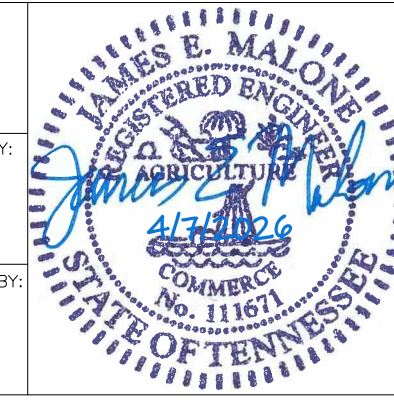

This information is released solely for its use in the interest of the Memphis-Shelby County Airport Authority (MSCAA) or its Tenants.
All drawings received from MSCAA or produced for or produced for MSCAA as a work product shall be regarded as privileged information, not to be released to others without the express written permission of MSCAA.
Your acceptance of the released materials establishes your understanding of, and commitment to, providing adequate control of the materials issued and produced.

REVISIONS

MARK	DATE	DESCRIPTION
	4/7/26	ISSUED FOR BID
△	4/28/26	ADDENDUM #1

MSCAA PROJ. NO. **18-1420-02-01**

PROJECT: **CHARLES BAKER
PAVEMENT IMPROVEMENTS
PHASE 2 - CONSTRUCTION**

SHEET TITLE: **GENERAL NOTES
AND
SUMMARY OF
QUANTITIES**

DWG. FILE NAME: **3327602-21C-QT-01.DWG**
DATE: **4/7/26** SHEET NO.: **C-QT-01**
SCALE: **N/A** SHEET: **9 OF 23**



CONTROL POINT	NORTHING	EASTING	ELEVATION
CP 7*	367919.710	794359.322	242.45
CP 8*	367813.292	794736.374	241.44
CP 9*	368263.298	794498.200	242.85
CP 10*	367537.652	794987.841	240.22
CP 11*	366975.178	794923.250	241.25
CP 12*	366889.539	794912.224	241.19
CP 13*	366733.944	794899.488	241.20
CP 14*	366658.114	794894.722	241.00
CP 15*	366545.808	794891.921	241.14
CP 16*	367468.337	794080.766	238.34
CP 17*	367131.053	794355.533	238.57
CP 18*	366884.590	794421.258	238.58
XTRAV/1051*	367058.445	794743.476	241.05
XTRAV/1052*	367103.750	794566.765	241.06

LEGEND

- X — EXISTING FENCE
- D — D — EXISTING STORM DRAINAGE
- EXISTING DRAINAGE STRUCTURE
- ⊙ EXISTING POWER POLE
- ⊗ EXISTING TREE
- ⊕ EXISTING AIRCRAFT TIE DOWN

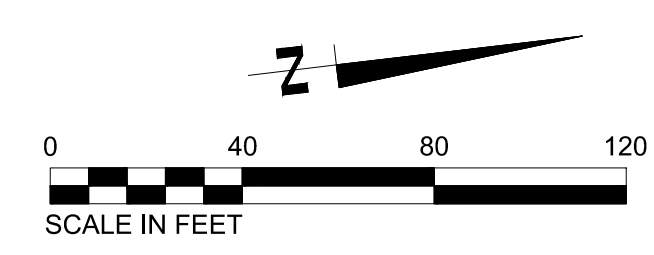

SURVEY PERFORMED BY THY, INC. (2020)

PROGRAM MANAGER

ENGINEER
BARGE
 DESIGN SOLUTIONS, INC.
 65 GERMANTOWN CT, SUITE 100
 MEMPHIS, TN 38018

JOB NO. 33276-02

DRAWN BY: JEM
 CHECKED BY: JAN
 APPROVED BY: JEG

This information is released solely for its use in the interest of the Memphis-Shelby County Airport Authority (MSCAA) or its Tenants. All drawings received from MSCAA or produced for MSCAA as a work product shall be regarded as privileged information, not to be released to others without the express written permission of MSCAA. Your acceptance of the released materials establishes your understanding of, and commitment to, providing adequate control of the materials issued and produced.

REVISIONS

MARK	DATE	DESCRIPTION
	4/7/26	ISSUED FOR BID
Δ	4/28/26	ADDENDUM #1

MSCAA PROJ. NO. 18-1420-02-01

PROJECT: CHARLES BAKER
 PAVEMENT IMPROVEMENTS
 PHASE 2 - CONSTRUCTION

SHEET TITLE: EXISTING CONDITIONS (AREAS 1 & 2)

DWG. FILE NAME: 3327602-31C-EX-01.DWG
 DATE: 4/7/26 SHEET NO. C-EX-01
 SCALE: 1"=40' SHEET 5 OF 23

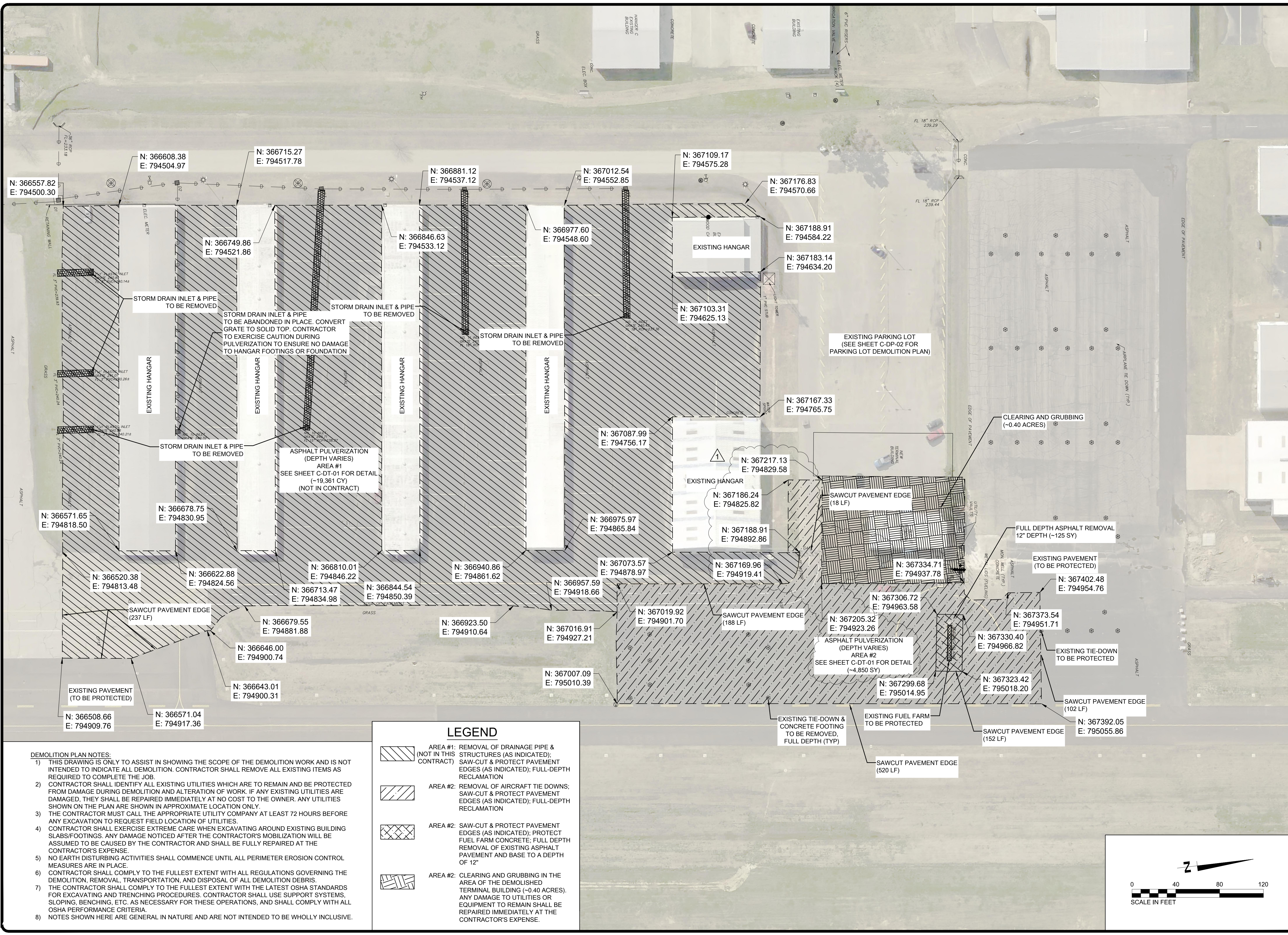

- DEMOLITION PLAN NOTES:**
- 1) THIS DRAWING IS ONLY TO ASSIST IN SHOWING THE SCOPE OF THE DEMOLITION WORK AND IS NOT INTENDED TO INDICATE ALL DEMOLITION. CONTRACTOR SHALL REMOVE ALL EXISTING ITEMS AS REQUIRED TO COMPLETE THE JOB.
 - 2) CONTRACTOR SHALL IDENTIFY ALL EXISTING UTILITIES WHICH ARE TO REMAIN AND BE PROTECTED FROM DAMAGE DURING DEMOLITION AND ALTERATION OF WORK. IF ANY EXISTING UTILITIES ARE DAMAGED, THEY SHALL BE REPAIRED IMMEDIATELY AT NO COST TO THE OWNER. ANY UTILITIES SHOWN ON THE PLAN ARE SHOWN IN APPROXIMATE LOCATION ONLY.
 - 3) THE CONTRACTOR MUST CALL THE APPROPRIATE UTILITY COMPANY AT LEAST 72 HOURS BEFORE ANY EXCAVATION TO REQUEST FIELD LOCATION OF UTILITIES.
 - 4) CONTRACTOR SHALL EXERCISE EXTREME CARE WHEN EXCAVATING AROUND EXISTING BUILDING SLABS/FOOTINGS. ANY DAMAGE NOTICED AFTER THE CONTRACTOR'S MOBILIZATION WILL BE ASSUMED TO BE CAUSED BY THE CONTRACTOR AND SHALL BE FULLY REPAIRED AT THE CONTRACTOR'S EXPENSE.
 - 5) NO EARTH DISTURBING ACTIVITIES SHALL COMMENCE UNTIL ALL PERIMETER EROSION CONTROL MEASURES ARE IN PLACE.
 - 6) CONTRACTOR SHALL COMPLY TO THE FULLEST EXTENT WITH ALL REGULATIONS GOVERNING THE DEMOLITION, REMOVAL, TRANSPORTATION AND DISPOSAL OF ALL DEMOLITION DEBRIS.
 - 7) THE CONTRACTOR SHALL COMPLY TO THE FULLEST EXTENT WITH THE LATEST OSHA STANDARDS FOR EXCAVATING AND TRENCHING PROCEDURES. CONTRACTOR SHALL USE SUPPORT SYSTEMS, SLOPING, BENCHING, ETC. AS NECESSARY FOR THESE OPERATIONS, AND SHALL COMPLY WITH ALL OSHA PERFORMANCE CRITERIA.
 - 8) NOTES SHOWN HERE ARE GENERAL IN NATURE AND ARE NOT INTENDED TO BE WHOLLY INCLUSIVE.

LEGEND

- AREA #1: REMOVAL OF DRAINAGE PIPE & STRUCTURES (AS INDICATED); SAW-CUT & PROTECT PAVEMENT EDGES (AS INDICATED); FULL-DEPTH RECLAMATION
- AREA #2: REMOVAL OF AIRCRAFT TIE DOWNS; SAW-CUT & PROTECT PAVEMENT EDGES (AS INDICATED); FULL-DEPTH RECLAMATION
- AREA #2: SAW-CUT & PROTECT PAVEMENT EDGES (AS INDICATED); PROTECT FUEL FARM CONCRETE; FULL DEPTH REMOVAL OF EXISTING ASPHALT PAVEMENT AND BASE TO A DEPTH OF 12"
- AREA #2: CLEARING AND GRUBBING IN THE AREA OF THE DEMOLISHED TERMINAL BUILDING (~0.40 ACRES). ANY DAMAGE TO UTILITIES OR EQUIPMENT TO REMAIN SHALL BE REPAIRED IMMEDIATELY AT THE CONTRACTOR'S EXPENSE.

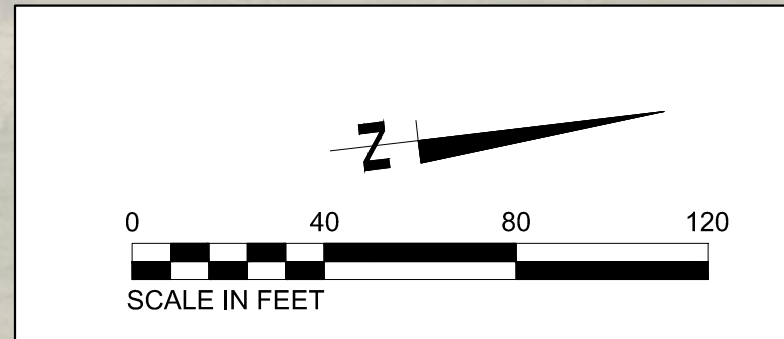

PROGRAM MANAGER
 ENGINEER
BARGE
 DESIGN SOLUTIONS, INC.
 65 GERMANTOWN CT, SUITE 100
 MEMPHIS, TN 38018
 JOB NO. 33276-02
 DRAWN BY: JEM
 CHECKED BY: JAN
 APPROVED BY: JEG

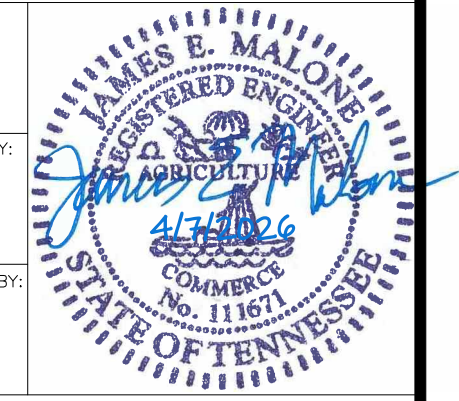

This information is released solely for its use in the interest of the Memphis-Spivey County Airport Authority (MSCAA) or its Tenants. All drawings received from MSCAA or produced for MSCAA as a work product shall be regarded as privileged information, not to be released to others without the express written permission of MSCAA. Your acceptance of the released materials establishes your understanding of, and commitment to, providing adequate control of the materials issued and produced.

REVISIONS

MARK	DATE	DESCRIPTION
	4/7/26	ISSUED FOR BID
▲	4/22/26	ADDENDUM #1

MSCAA PROJ. NO. 18-1420-02-01



PROJECT: CHARLES BAKER
 PAVEMENT IMPROVEMENTS
 PHASE 2 - CONSTRUCTION

SHEET TITLE: DEMOLITION PLAN (AREAS 1 & 2)

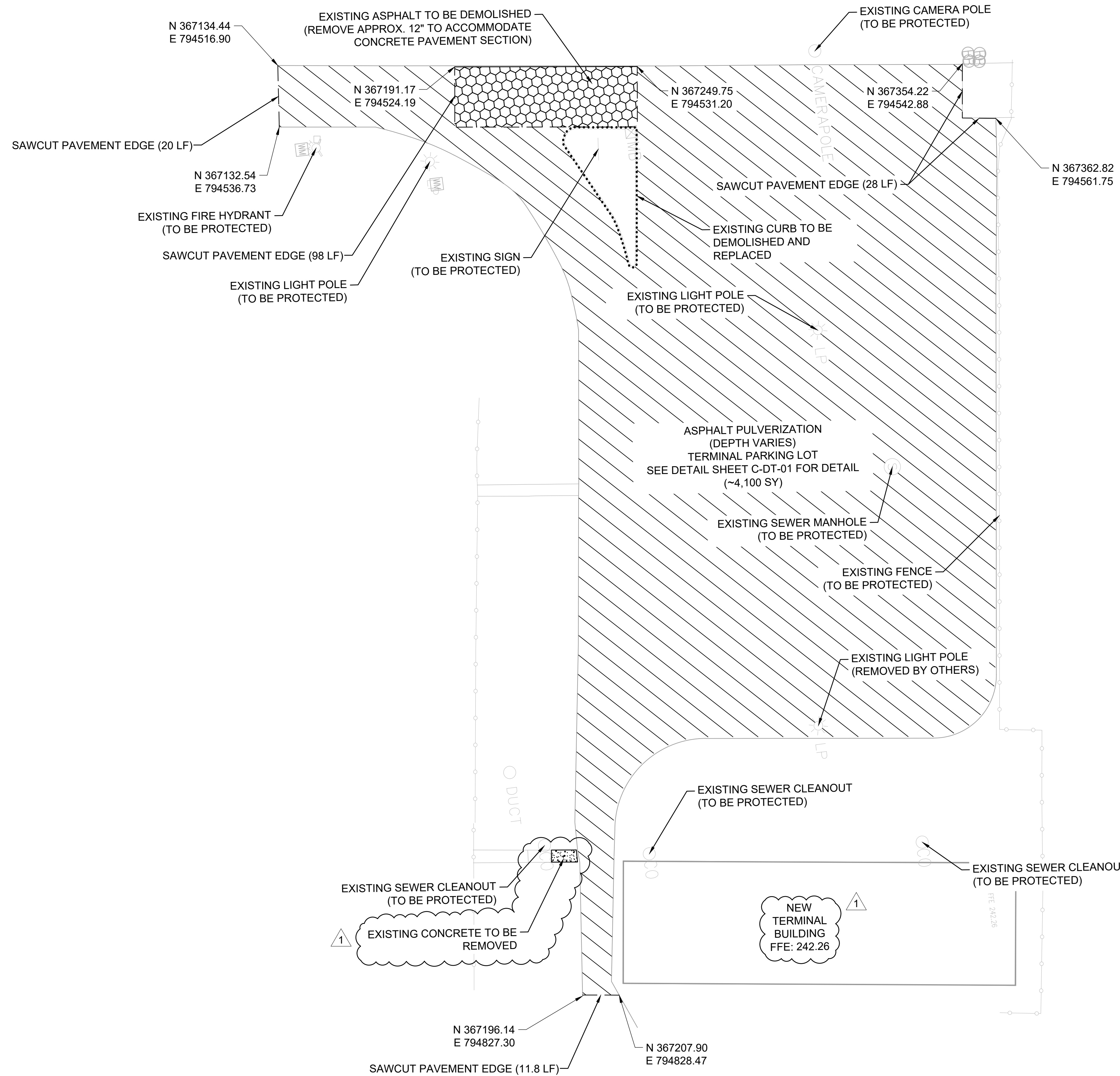
DWG. FILE NAME: 3327602-41C-DP-01.DWG
 DATE: 4/7/26 SHEET NO. C-DP-01
 SCALE: 1"=40' SHEET 7 OF 23

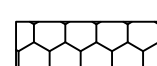
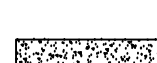

LEGEND

-  PARKING LOT: EXISTING PARKING LOT TO RECEIVE FULL DEPTH RECLAMATION
-  PARKING LOT: EXISTING PARKING LOT TO BE DEMOLISHED
-  SIDEWALK: EXISTING CONCRETE TO BE DEMOLISHED
-  SAWCUT LINE
-  EXISTING CURB TO BE DEMOLISHED

- DEMOLITION PLAN NOTES:**
- 1) THIS DRAWING IS ONLY TO ASSIST IN SHOWING THE SCOPE OF THE DEMOLITION WORK AND IS NOT INTENDED TO INDICATE ALL DEMOLITION. CONTRACTOR SHALL REMOVE ALL EXISTING ITEMS AS REQUIRED TO COMPLETE THE JOB.
 - 2) CONTRACTOR SHALL IDENTIFY ALL EXISTING UTILITIES WHICH ARE TO REMAIN AND BE PROTECTED FROM DAMAGE DURING DEMOLITION AND ALTERATION OF WORK. IF ANY EXISTING UTILITIES ARE DAMAGED, THEY SHALL BE REPAIRED IMMEDIATELY AT NO COST TO THE OWNER. ANY UTILITIES SHOWN ON THE PLAN ARE SHOWN IN APPROXIMATE LOCATION ONLY.
 - 3) THE CONTRACTOR MUST CALL THE APPROPRIATE UTILITY COMPANY AT LEAST 72 HOURS BEFORE ANY EXCAVATION TO REQUEST FIELD LOCATION OF UTILITIES.
 - 4) CONTRACTOR SHALL EXERCISE EXTREME CARE WHEN EXCAVATING AROUND EXISTING BUILDING SLABS/FOOTINGS. ANY DAMAGE NOTICED AFTER THE CONTRACTOR'S MOBILIZATION WILL BE ASSUMED TO BE CAUSED BY THE CONTRACTOR AND SHALL BE FULLY REPAIRED AT THE CONTRACTOR'S EXPENSE.
 - 5) NO EARTH DISTURBING ACTIVITIES SHALL COMMENCE UNTIL ALL PERIMETER EROSION CONTROL MEASURES ARE IN PLACE.
 - 6) CONTRACTOR SHALL COMPLY TO THE FULLEST EXTENT WITH ALL REGULATIONS GOVERNING THE DEMOLITION, REMOVAL, TRANSPORTATION, AND DISPOSAL OF ALL DEMOLITION DEBRIS.
 - 7) THE CONTRACTOR SHALL COMPLY TO THE FULLEST EXTENT WITH THE LATEST OSHA STANDARDS FOR EXCAVATING AND TRENCHING PROCEDURES. CONTRACTOR SHALL USE SUPPORT SYSTEMS, SLOPING, BENCHING, ETC. AS NECESSARY FOR THESE OPERATIONS, AND SHALL COMPLY WITH ALL OSHA PERFORMANCE CRITERIA.
 - 8) NOTES SHOWN HERE ARE GENERAL IN NATURE AND ARE NOT INTENDED TO BE WHOLLY INCLUSIVE.

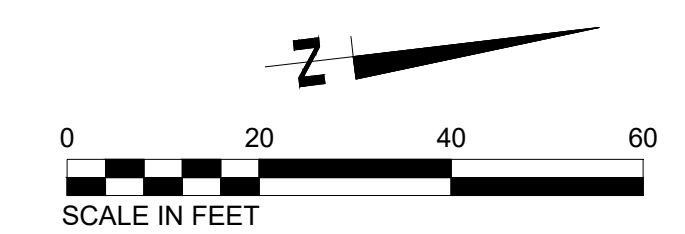

PROGRAM MANAGER

ENGINEER
BARGE
 DESIGN SOLUTIONS, INC.
 65 GERMANTOWN CT, SUITE 100
 MEMPHIS, TN 38018

JOB NO. 33276-02

DRAWN BY: JEM
 CHECKED BY: JAN
 APPROVED BY: JEG

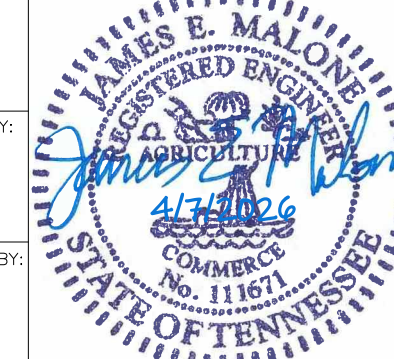

This information is released solely for its use in the interest of the Memphis-Shelby County Airport Authority (MSCAA) or its Tenants. All drawings received from MSCAA or produced for MSCAA as a work product shall be regarded as privileged information, not to be released to others without the express written permission of MSCAA. Your acceptance of the released materials establishes your understanding of, and commitment to, providing adequate control of the materials issued and produced.

REVISIONS		
MARK	DATE	DESCRIPTION
	4/7/26	ISSUED FOR BID
1	4/28/26	ADDENDUM #1

MSCAA PROJ. NO. 18-1420-02-01

PROJECT: CHARLES BAKER
 PAVEMENT IMPROVEMENTS
 PHASE 2 - CONSTRUCTION

SHEET TITLE:
DEMOLITION PLAN (PARKING LOT)

DWG. FILE NAME: 3327602-41C-DP-02.DWG
 DATE: 4/7/26 SHEET NO.: C-DP-02
 SCALE: 1"=20' SHEET: 8 OF 23

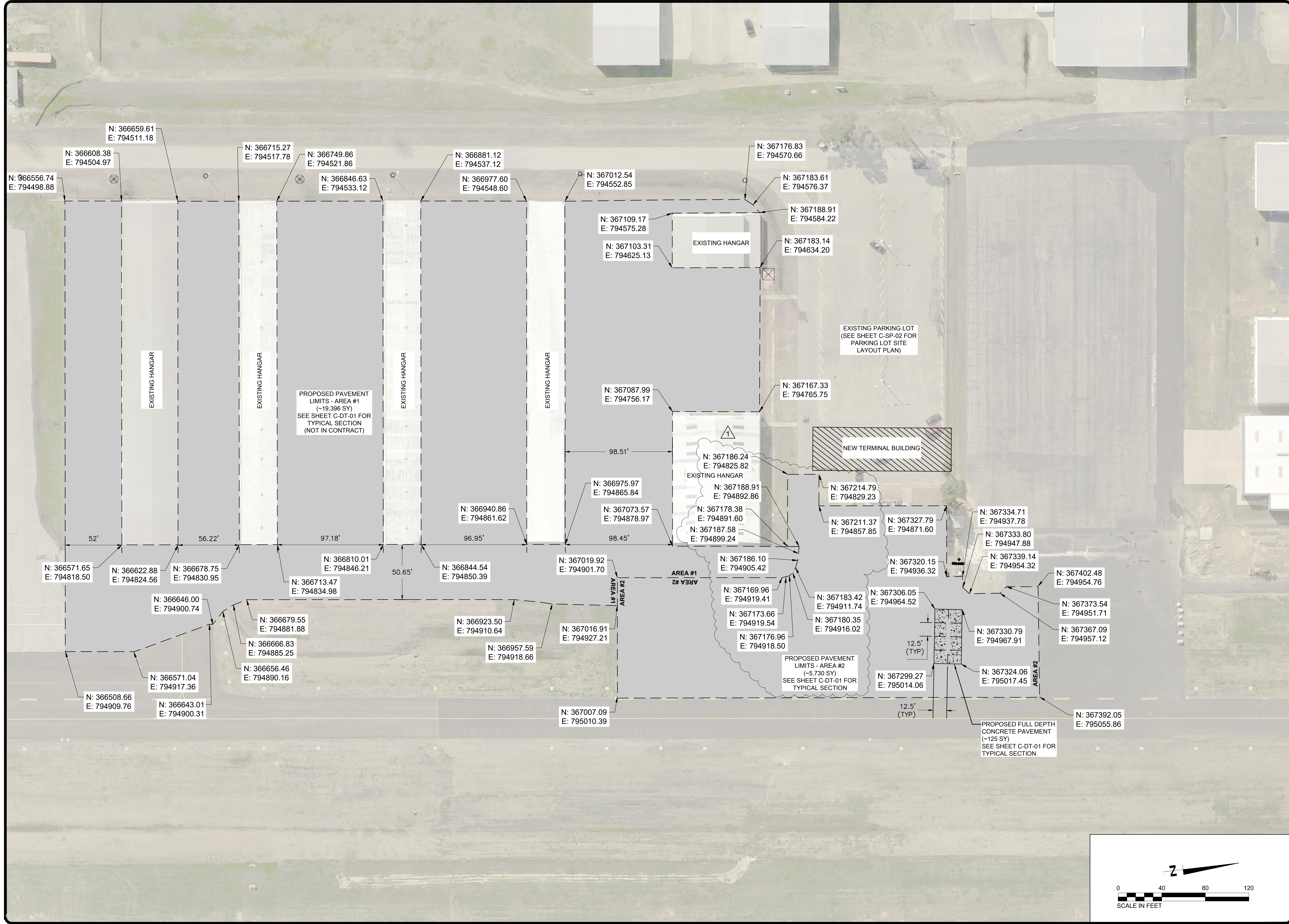

PROGRAM MANAGER

ENGINEER
BARGE
 DESIGN SOLUTIONS, INC.
 65 GERMANTOWN CT, SUITE 100
 MEMPHIS, TN 38018

JOB NO.
33276-02

DRAWN BY:
JEM

CHECKED BY:
JAN

APPROVED BY:
JEG

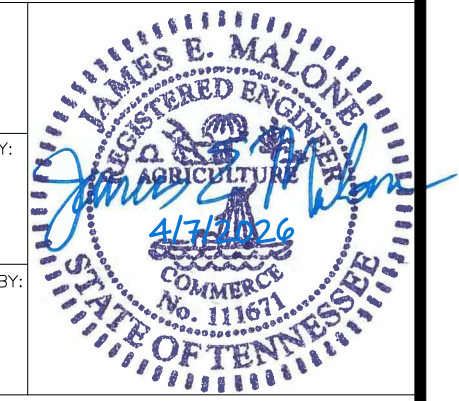

This information is released solely for its use in the interest of the Memphis-Shelby County Airport Authority (MSCAA) or its Tenants.
 All drawings received from MSCAA or produced for MSCAA as a work product shall be regarded as privileged information, not to be released to others without the express written permission of MSCAA.
 Your acceptance of the released materials establishes your understanding of, and commitment to, providing adequate control of the materials issued and produced.

REVISIONS

MARK	DATE	DESCRIPTION
	4/7/26	ISSUED FOR BID
△	4/28/26	ADDENDUM #1

MSCAA PROJ. NO.
18-1420-02-01

PROJECT:
CHARLES BAKER
PAVEMENT IMPROVEMENTS
PHASE 2 - CONSTRUCTION

SHEET TITLE:
SITE LAYOUT PLAN
(AREAS 1 & 2)

DWG. FILE NAME
3327602-51C-SP-01.DWG

DATE
4/7/26

SHEET NO.
C-SP-01

SCALE
1"=40'

SHEET
9 OF 23

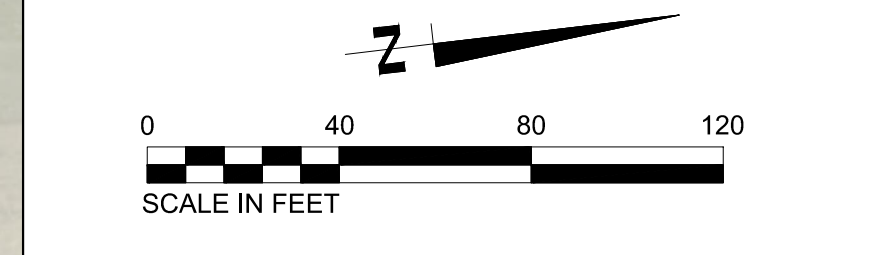

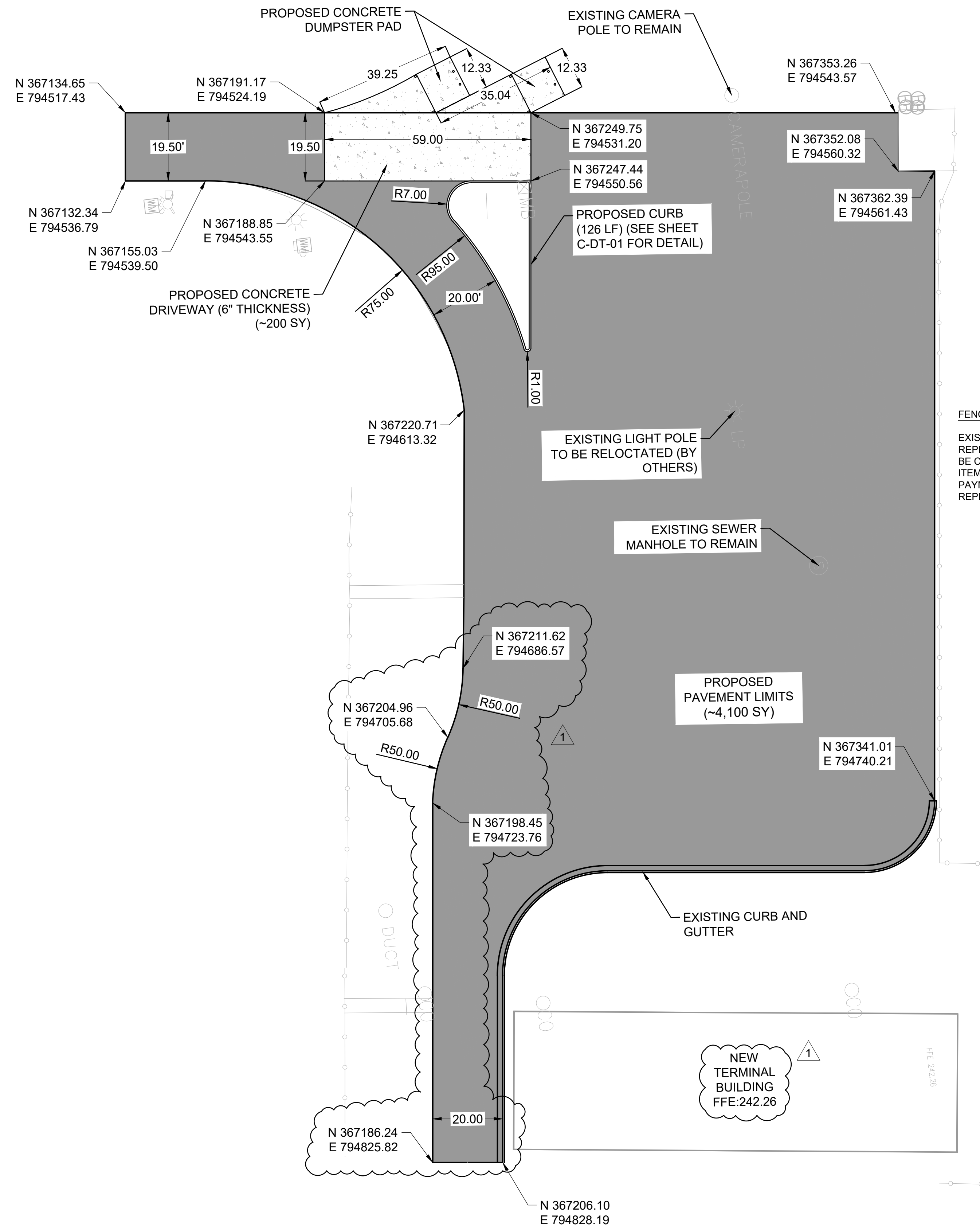

FENCE NOTE:

EXISTING FENCE REQUIRED TO BE REMOVED AND REPLACED TO PERFORM PAVING OPERATIONS SHALL BE CONSIDERED INCIDENTAL TO APPROPRIATE PAY ITEM TDOT-411D FOR PAVEMENT. NO SEPARATE PAYMENT WILL BE MADE FOR REMOVAL AND REPLACEMENT OF EXISTING FENCE.

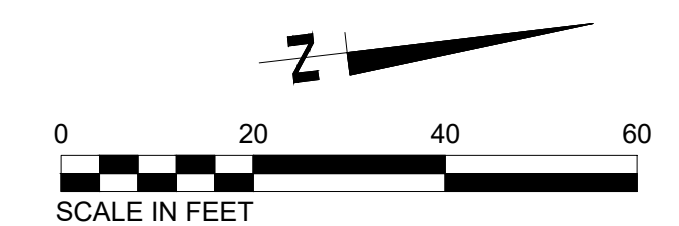

PROGRAM MANAGER

ENGINEER



BARGE DESIGN SOLUTIONS, INC.
 65 GERMANTOWN CT, SUITE 100
 MEMPHIS, TN 38018

JOB NO. **33276-02**

DRAWN BY:

JEM

CHECKED BY:

JAN

APPROVED BY:

JEG

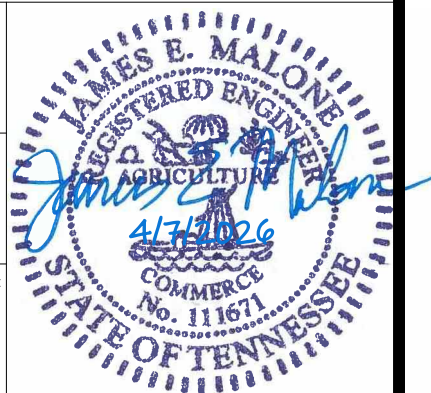

This information is released solely for its use in the interest of the Memphis-Shelby County Airport Authority (MSCAA) or its Tenants.
 All drawings received from MSCAA or produced for or produced for MSCAA as a work product shall be regarded as privileged information, not to be released to others without the express written permission of MSCAA.
 Your acceptance of the released materials establishes your understanding of, and commitment to, providing adequate control of the materials issued and produced.

REVISIONS

MARK	DATE	DESCRIPTION
	4/7/26	ISSUED FOR BID
1	4/28/26	ADDENDUM #1

MSCAA PROJ. NO.
18-1420-02-01

PROJECT:
**CHARLES BAKER
 PAVEMENT IMPROVEMENTS
 PHASE 2 - CONSTRUCTION**

SHEET TITLE:

**SITE LAYOUT PLAN
 (PARKING LOT)**

DWG. FILE NAME

DATE
4/7/26

SCALE
1"=20'

SHEET NO.
C-SP-02

SHEET
10 OF 23

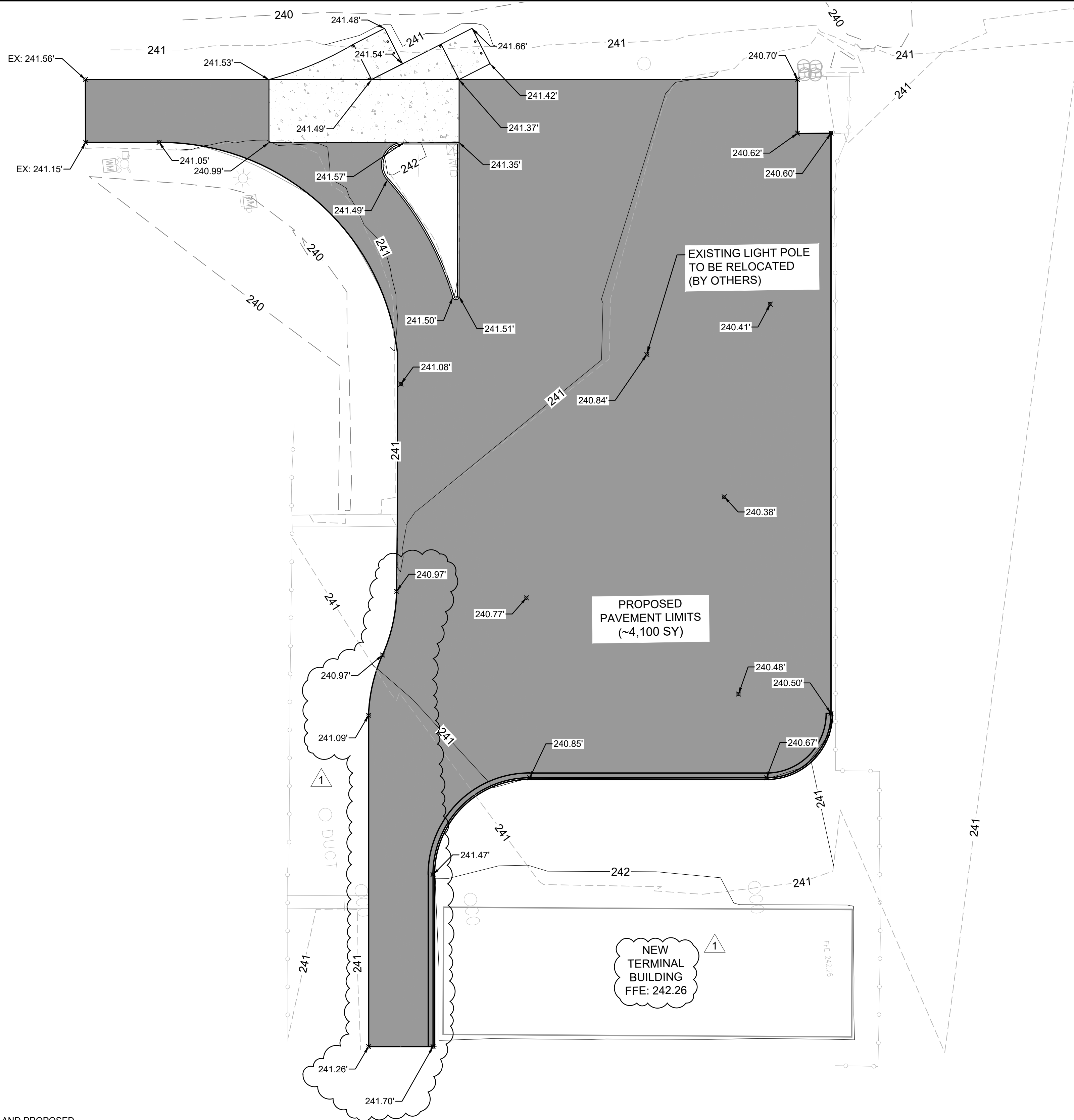

- GRADING NOTES:**
1. ALL PROPOSED CONTOURS REPRESENT PROPOSED FINISHED SURFACE GRADE.
 2. PROPOSED TYPICAL SECTIONS SHALL PROVIDE A SMOOTH TRANSITION BETWEEN EXISTING AND PROPOSED SURFACES. MATCH EXISTING ELEVATION WHEN TYING INTO ADJACENT PAVEMENTS. FOR AREAS NOT ADJACENT TO EXISTING PAVEMENT, PROVIDE 1.5" DROP FROM TOP OF PAVEMENT TO SOD. REFERENCE TYPICAL SECTIONS SHOWN ON C-DT-01 FOR MORE DETAILS.
 3. AT ALL TIMES MAINTAIN THE AREA SO IT WILL BE WELL DRAINED IN ACCORDANCE WITH THE EROSION AND SEDIMENT CONTROL REQUIREMENTS. THE EROSION CONTROL DEVICES SHALL BE THE FIRST ITEM OF CONSTRUCTION AND REMAIN FUNCTIONAL. THEY WILL REQUIRE PERIODIC MAINTENANCE AS PART OF THE CONTRACT. REFER TO SHEETS C-EC-01 THRU C-EC-03-01 FOR DETAILS. ALL PROPOSED GRADING SHALL BE CONSIDERED UNCLASSIFIED. IT IS UNDERSTOOD THAT ANY REFERENCE TO ROCK, EARTH, OR OTHER MATERIALS ON THE DRAWINGS IS NOT AN INDICATION OF CLASSIFIED EXCAVATION.
 4. STRIP AND STOCKPILE ALL TOPSOIL IN CUT AND FILL AREAS. PROVIDE ADEQUATE EROSION AND SEDIMENT CONTROL FOR ALL STOCKPILES. TAKE CARE TO AVOID MIXING SUBSOIL AND OTHER UNSUITABLE MATERIAL WITH THE TOPSOIL.
 5. DISTURB ONLY THOSE AREAS NECESSARY FOR THE CURRENT PHASE OF WORK. THE CONTRACTOR IS RESPONSIBLE FOR AND SHALL PROTECT ANY AND ALL EXISTING UTILITIES, STRUCTURES, PIPES, CULVERTS, CONDUITS, WIRES, OR OTHER ITEMS TO REMAIN. THE CONTRACTOR SHALL, AT THEIR OWN EXPENSE, REPAIR OR REPLACE ANY DAMAGE THAT MAY RESULT FROM THEIR OPERATIONS.
 6. AFTER COMPLETION OF STRIPPING IN FILL AREAS AND ONCE GRADE IS ACHIEVED IN CUT AREAS, PROOFROLL AS DIRECTED BY THE GEOTECHNICAL ENGINEER. UNDERCUT AND BACKFILL ANY UNSUITABLE MATERIALS AS DIRECTED BY THE GEOTECHNICAL ENGINEER.
 7. FILL MATERIAL SHALL CONTAIN NO ROCK FRAGMENTS LARGER THAN FOUR INCHES IN ANY DIMENSION AND NO ORGANIC MATTER.

LEGEND

- 240 --- EXISTING MAJOR CONTOUR
- 239 --- EXISTING MINOR CONTOUR
- 240 — PROPOSED MAJOR CONTOUR
- 241 — PROPOSED MINOR CONTOUR

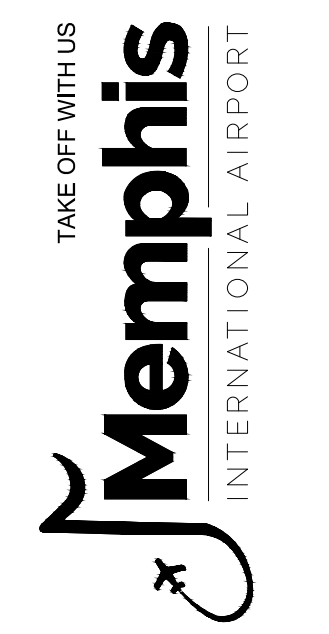
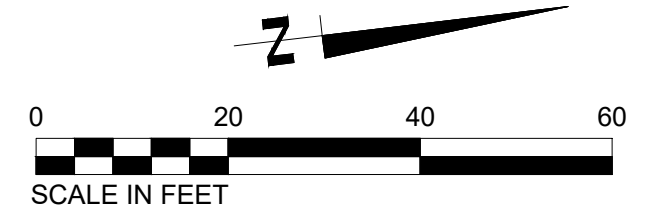

PROGRAM MANAGER

ENGINEER
BARGE
 DESIGN SOLUTIONS, INC.
 65 GERMANTOWN CT, SUITE 100
 MEMPHIS, TN 38018

JOB NO. 33276-02

DRAWN BY: JEM
 CHECKED BY: JAN
 APPROVED BY: JEG

This information is released solely for its use in the interest of the Memphis-Shelby County Airport Authority (MSCAA) or its Tenants. All drawings received from MSCAA or produced for MSCAA as a work product shall be regarded as privileged information, not to be released to others without the express written permission of MSCAA. Your acceptance of the released materials establishes your understanding of, and commitment to, providing adequate control of the materials issued and produced.

REVISIONS

MARK	DATE	DESCRIPTION
	4/7/26	ISSUED FOR BID
1	4/28/26	ADDENDUM #1

MSCAA PROJ. NO. 18-1420-02-01

PROJECT: CHARLES BAKER
 PAVEMENT IMPROVEMENTS
 PHASE 2 - CONSTRUCTION

SHEET TITLE: SITE GRADING PLAN (PARKING LOT)

DWG. FILE NAME
 DATE 4/7/26 SHEET NO. C-GR-02
 SCALE 1"=20' SHEET 12 OF 23

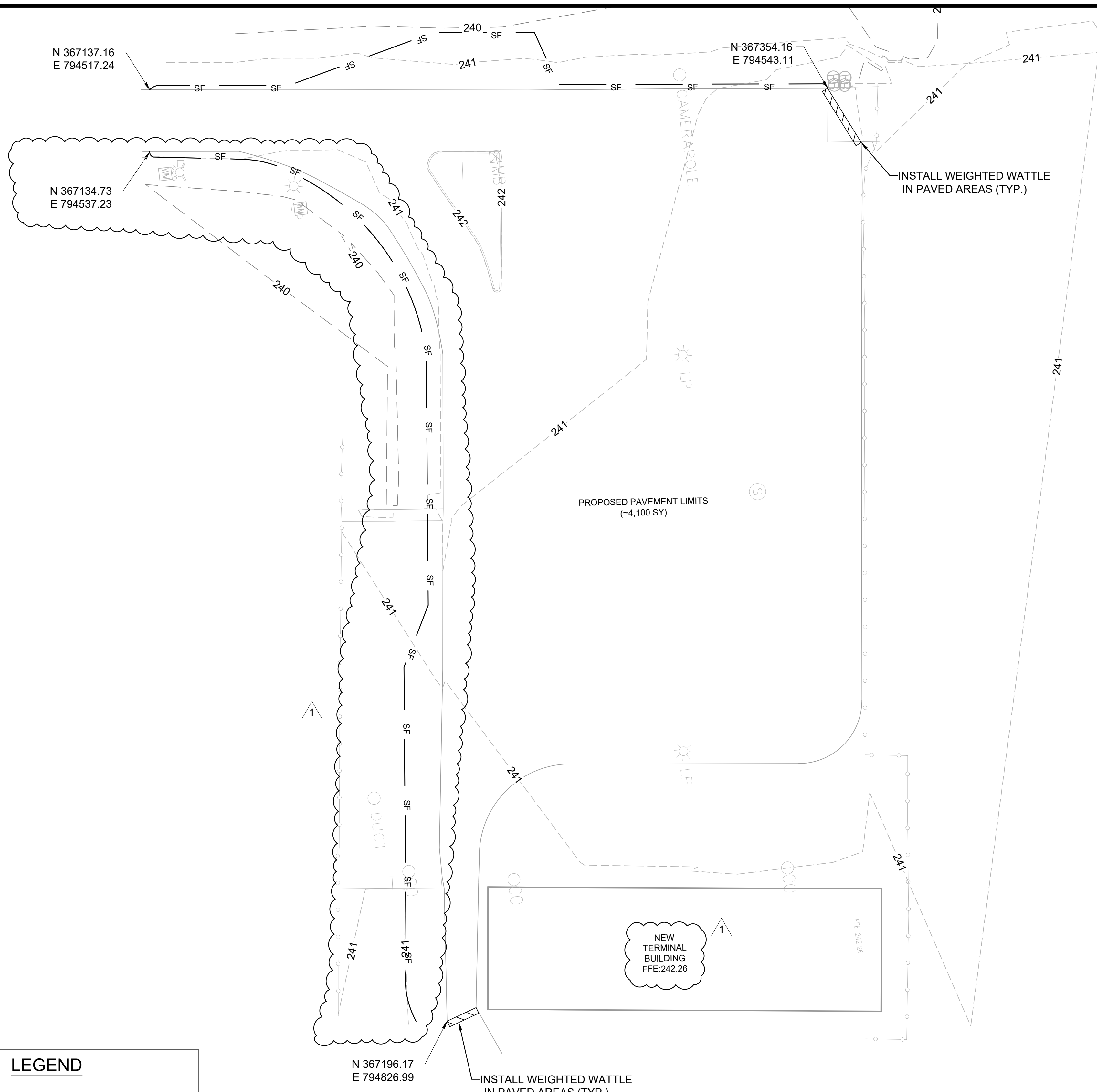

EROSION CONTROL NOTES:

- 1) THE CONTRACTOR SHALL CONSULT THE LATEST EDITION OF THE TENNESSEE EROSION AND SEDIMENT CONTROL HANDBOOK FOR FACT SHEETS AND DETAILS FOR INFORMATION AND GUIDANCE IN APPLYING TEMPORARY CONSTRUCTION SITE MANAGEMENT PRACTICES (TCPS) TO DISTURBED AREAS INCLUDING CONSTRUCTION EXIT, SILT FENCE, INLET PROTECTION, CHECK DAMS, TURF REINFORCED MATTING, RIPRAP ETC.
- 2) ALL DIMENSIONS AND LOCATIONS OF TEMPORARY SOIL EROSION AND WATER POLLUTION CONTROL DEVICES SHALL BE SUBJECT TO ADJUSTMENT AS DESIGNATED BY THE ENGINEER.
- 3) WHEN THE TEMPORARY SOIL EROSION AND WATER POLLUTION CONTROL DEVICES ARE NO LONGER REQUIRED FOR THE INTENDED PURPOSE, IN THE OPINION OF ENGINEER, THEY SHALL BE REMOVED.
- 4) CONTRACTOR TO NOTIFY THE AIRPORT AND TDOT THREE DAYS PRIOR TO BEGIN WORK.
- 5) ALL GRADE AREAS INCLUDING SLOPES ARE TO BE MULCHED AND SEEDED WITHIN 14 DAYS AFTER GRADING IS COMPLETE.
- 6) THE CONTRACTOR SHALL INSTALL THE CONSTRUCTION EXIT BEFORE ANY OTHER WORK IS COMPLETED.
- 7) INSTALL PERIMETER SILT FENCE AROUND THE STAGING/ STOCKPILE AREA.

LEGEND

	240	EXISTING MAJOR CONTOUR
	230	EXISTING MINOR CONTOUR
	SF	SILT FENCE
		WEIGHTED WATTLE

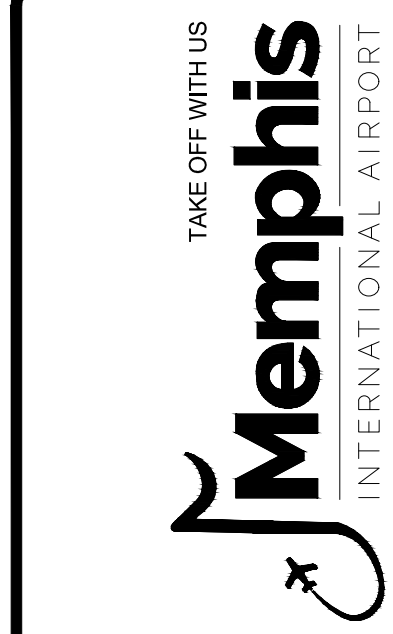

PROGRAM MANAGER

ENGINEER
BARGE
 DESIGN SOLUTIONS, INC.
 65 GERMANTOWN CT, SUITE 100
 MEMPHIS, TN 38018

JOB NO. 33276-02

DRAWN BY:

JEM

CHECKED BY:

JAN

APPROVED BY:

JEG

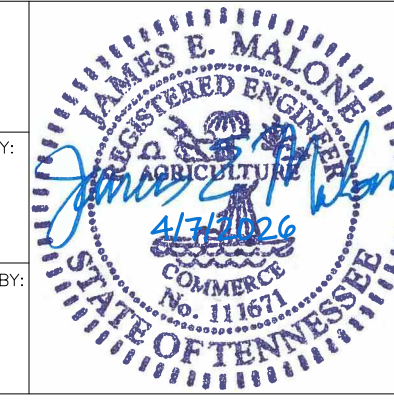

This information is released solely for its use in the interest of the Memphis-Shelby County Airport Authority (MSCAA) or its Tenants.
 All drawings received from MSCAA or produced for MSCAA as a work product shall be regarded as privileged information, not to be released to others without the express written permission of MSCAA.
 Your acceptance of the released materials establishes your understanding of, and commitment to, providing adequate control of the materials issued and produced.

REVISIONS

MARK	DATE	DESCRIPTION
	4/7/26	ISSUED FOR BID
1	4/28/26	ADDENDUM #1

MSCAA PROJ. NO. 18-1420-02-01

PROJECT: CHARLES BAKER
 PAVEMENT IMPROVEMENTS
 PHASE 2 - CONSTRUCTION

SHEET TITLE:
**EROSION CONTROL PLAN
 PRE-CONSTRUCTION
 (PARKING LOT)**

DWG. FILE NAME: 3327602-72C-EC-03.01.DWG
 DATE: 4/7/26 SHEET NO. C-EC-2.01
 SCALE: 1"=20' SHEET: 16 OF 23

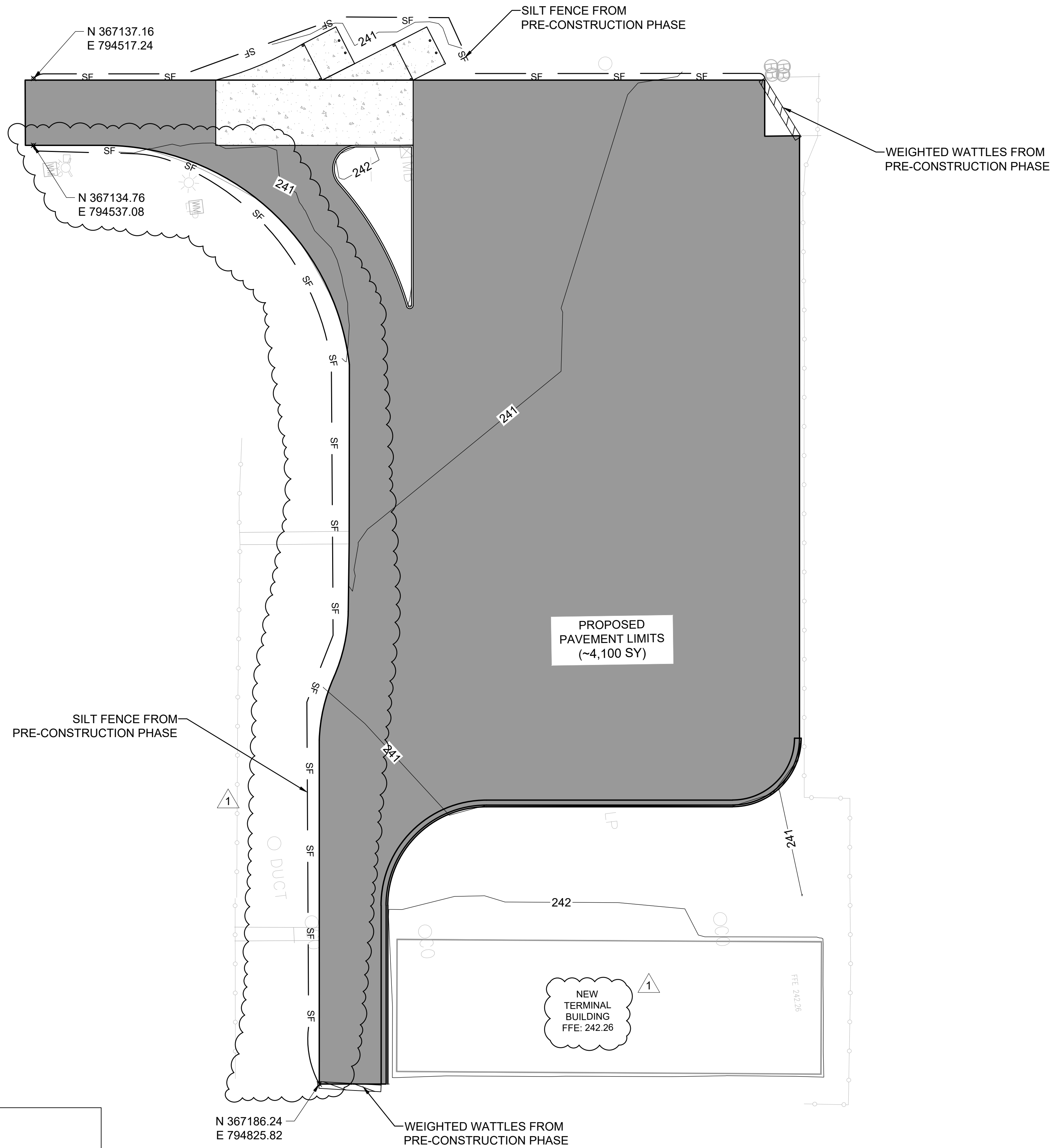

EROSION CONTROL NOTES:

- 1) THE CONTRACTOR SHALL CONSULT THE LATEST EDITION OF THE TENNESSEE EROSION AND SEDIMENT CONTROL HANDBOOK FOR FACT SHEETS AND DETAILS FOR INFORMATION AND GUIDANCE IN APPLYING TEMPORARY CONSTRUCTION SITE MANAGEMENT PRACTICES (TCPS) TO DISTURBED AREAS INCLUDING CONSTRUCTION EXIT, SILT FENCE, INLET PROTECTION, CHECK DAMS, TURF REINFORCED MATTING, RIPRAP ETC.
- 2) ALL DIMENSIONS AND LOCATIONS OF TEMPORARY SOIL EROSION AND WATER POLLUTION CONTROL DEVICES SHALL BE SUBJECT TO ADJUSTMENT AS DESIGNATED BY THE ENGINEER.
- 3) WHEN THE TEMPORARY SOIL EROSION AND WATER POLLUTION CONTROL DEVICES ARE NO LONGER REQUIRED FOR THE INTENDED PURPOSE, IN THE OPINION OF ENGINEER, THEY SHALL BE REMOVED.
- 4) CONTRACTOR TO NOTIFY THE AIRPORT AND TDOT THREE DAYS PRIOR TO BEGIN WORK.
- 5) ALL GRADE AREAS INCLUDING SLOPES ARE TO BE MULCHED AND SEEDED WITHIN 14 DAYS AFTER GRADING IS COMPLETE.
- 6) THE CONTRACTOR SHALL INSTALL THE CONSTRUCTION EXIT BEFORE ANY OTHER WORK IS COMPLETED.
- 7) INSTALL PERIMETER SILT FENCE AROUND THE STAGING/ STOCKPILE AREA.

LEGEND

- 240— PROPOSED MAJOR CONTOUR
- 241— PROPOSED MINOR CONTOUR
- SF SILT FENCE
- ▨ WEIGHTED WATTLE

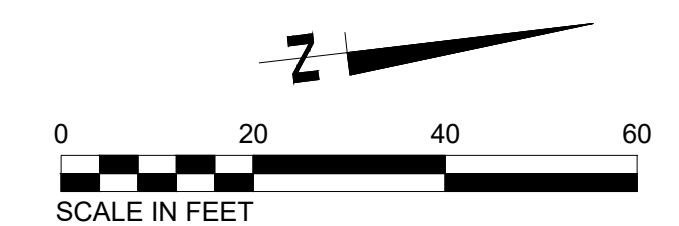

PROGRAM MANAGER

ENGINEER



BARGE DESIGN SOLUTIONS, INC.
 65 GERMANTOWN CT, SUITE 100
 MEMPHIS, TN 38018

JOB NO. 33276-02

DRAWN BY:

JEM

CHECKED BY:

JAN

APPROVED BY:

JEG



This information is released solely for its use in the interest of the Memphis-Shelby County Airport Authority (MSCAA) or its Tenants.
 All drawings received from MSCAA or produced for MSCAA as a work product shall be regarded as privileged information, not to be released to others without the express written permission of MSCAA.
 Your acceptance of the released materials establishes your understanding of, and commitment to, providing adequate control of the materials issued and produced.

REVISIONS

MARK	DATE	DESCRIPTION
	4/7/26	ISSUED FOR BID
1	4/28/26	ADDENDUM #1

MSCAA PROJ. NO. 18-1420-02-01

PROJECT: CHARLES BAKER
**PAVEMENT IMPROVEMENTS
 PHASE 2 - CONSTRUCTION**

SHEET TITLE:
**EROSION CONTROL
 PLAN
 DURING
 CONSTRUCTION
 (PARKING LOT)**

DWG. FILE NAME: 3327602-72C-EC-03.02.DWG
 DATE: 4/7/26 SHEET NO. C-EC-2.02
 SCALE: 1"=20' SHEET 17 OF 23

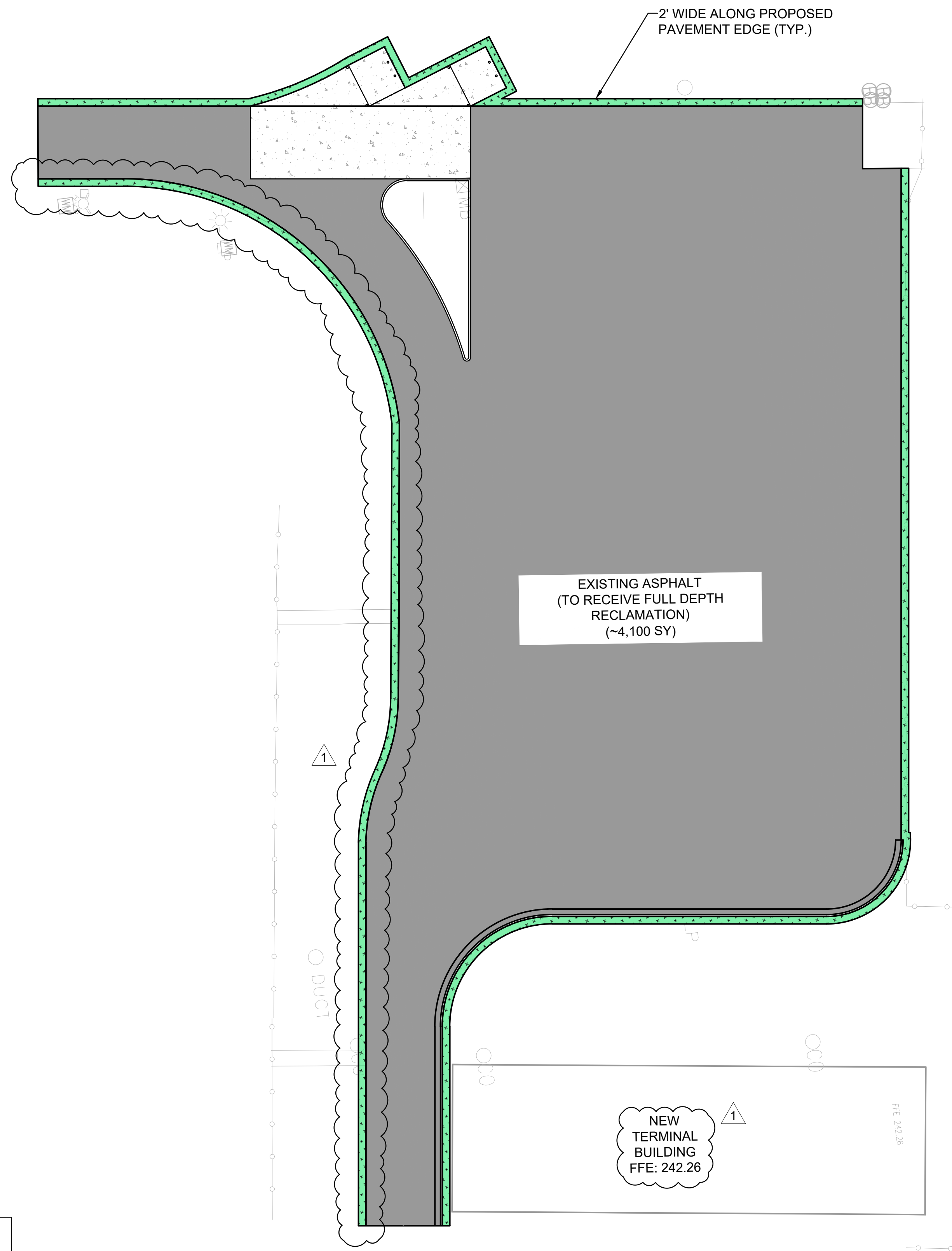

EROSION CONTROL NOTES:

- 1) THE CONTRACTOR SHALL CONSULT THE LATEST EDITION OF THE TENNESSEE EROSION AND SEDIMENT CONTROL HANDBOOK FOR FACT SHEETS AND DETAILS FOR INFORMATION AND GUIDANCE IN APPLYING TEMPORARY CONSTRUCTION SITE MANAGEMENT PRACTICES (TCPS) TO DISTURBED AREAS INCLUDING CONSTRUCTION EXIT, SILT FENCE, INLET PROTECTION, CHECK DAMS, TURF REINFORCED MATTING, RIPRAP ETC.
- 2) ALL DIMENSIONS AND LOCATIONS OF TEMPORARY SOIL EROSION AND WATER POLLUTION CONTROL DEVICES SHALL BE SUBJECT TO ADJUSTMENT AS DESIGNATED BY THE ENGINEER.
- 3) WHEN THE TEMPORARY SOIL EROSION AND WATER POLLUTION CONTROL DEVICES ARE NO LONGER REQUIRED FOR THE INTENDED PURPOSE, IN THE OPINION OF ENGINEER, THEY SHALL BE REMOVED.
- 4) CONTRACTOR TO NOTIFY THE AIRPORT AND TDOT THREE DAYS PRIOR TO BEGIN WORK.
- 5) ALL GRADE AREAS INCLUDING SLOPES ARE TO BE MULCHED AND SEEDED WITHIN 14 DAYS AFTER GRADING IS COMPLETE.
- 6) THE CONTRACTOR SHALL INSTALL THE CONSTRUCTION EXIT BEFORE ANY OTHER WORK IS COMPLETED.
- 7) INSTALL PERIMETER SILT FENCE AROUND THE STAGING/ STOCKPILE AREA.

LEGEND

- 240 PROPOSED MAJOR CONTOUR
- 241 PROPOSED MINOR CONTOUR
- PROPOSED SOD

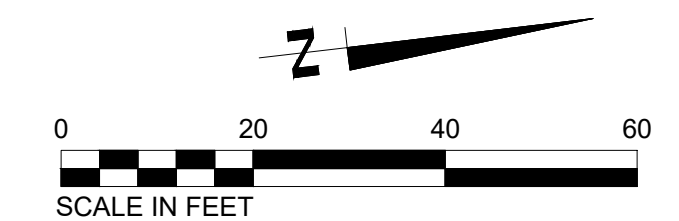

PROGRAM MANAGER

ENGINEER
BARGE
 DESIGN SOLUTIONS
BARGE DESIGN SOLUTIONS, INC.
 65 GERMANTOWN CT, SUITE 100
 MEMPHIS, TN 38018

JOB NO. 33276-02

DRAWN BY:

JEM

CHECKED BY:

JAN

APPROVED BY:

JEG



This information is released solely for its use in the interest of the Memphis-Shelby County Airport Authority (MSCAA) or its Tenants. All drawings received from MSCAA or produced for MSCAA as a work product shall be regarded as privileged information, not to be released to others without the express written permission of MSCAA.
 Your acceptance of the released materials establishes your understanding of, and commitment to, providing adequate control of the materials issued and produced.

REVISIONS

MARK	DATE	DESCRIPTION
	4/7/26	ISSUED FOR BID
1	4/28/26	ADDENDUM #1

MSCAA PROJ. NO. 18-1420-02-01

PROJECT: CHARLES BAKER
 PAVEMENT IMPROVEMENTS
 PHASE 2 - CONSTRUCTION

SHEET TITLE:
**EROSION CONTROL
 PLAN
 POST
 CONSTRUCTION
 (PARKING LOT)**

DWG. FILE NAME: 3327602-72C-EC-03.03.DWG
 DATE: 4/7/26 SHEET NO.: C-EC-2.03
 SCALE: 1"=20' SHEET: 18 OF 23

MARKING PLAN NOTES:

1. A PERIOD OF 30 DAYS SHALL ELAPSE BETWEEN PLACEMENT OF SURFACE COURSE OR SEAL COAT AND THE APPLICATION OF PERMANENT PAINT MARKINGS. TEMPORARY MARKINGS SHALL BE APPLIED AS SOON AS PRACTICAL AFTER THE PLACEMENT OF SURFACE COURSE OR SEAL COAT. PAINT SHALL BE APPLIED AT THE LOCATIONS AND TO THE DIMENSIONS AND SPACING SHOWN ON THE PLANS. PAINT SHALL NOT BE APPLIED UNTIL THE LAYOUT AND CONDITION OF THE SURFACE HAS BEEN APPROVED BY THE RPR. PRIOR TO THE FULL APPLICATION OF AIRFIELD MARKINGS, THE CONTRACTOR SHALL PREPARE A CONTROL STRIP IN THE PRESENCE OF THE RPR. THE CONTRACTOR SHALL DEMONSTRATE THE SURFACE PREPARATION METHOD AND ALL STRIPING EQUIPMENT TO USED ON THE PROJECT. THE MARKING EQUIPMENT MUST ACHIEVE THE PRESCRIBED APPLICATION RATE OF PAINT AND POPULATION OF GLASS BEADS (PER P-620) THAT ARE PROPERLY EMBEDDED AND EVENLY DISTRIBUTED ACROSS THE FULL WIDTH OF THE MARKING. PRIOR TO ACCEPTANCE OF THE CONTROL STRIP, MARKINGS MUST BE EVALUATED DURING DARKNESS TO ENSURE A UNIFORM APPEARANCE.
2. REFLECTANCE SHALL BE MEASURED WITH A PORTABLE RETRO-REFLECTOMETER MEETING ASTM E1710 (OR EQUIVALENT). A TOTAL OF 6 READINGS SHALL BE TAKEN OVER A 6 SQUARE FOOT AREA WITH 3 READINGS TAKEN FROM EACH DIRECTION. THE AVERAGE SHALL BE EQUAL TO OR ABOVE THE MINIMUM LEVELS OF ALL READINGS WHICH ARE WITHIN 30% OF EACH OTHER.

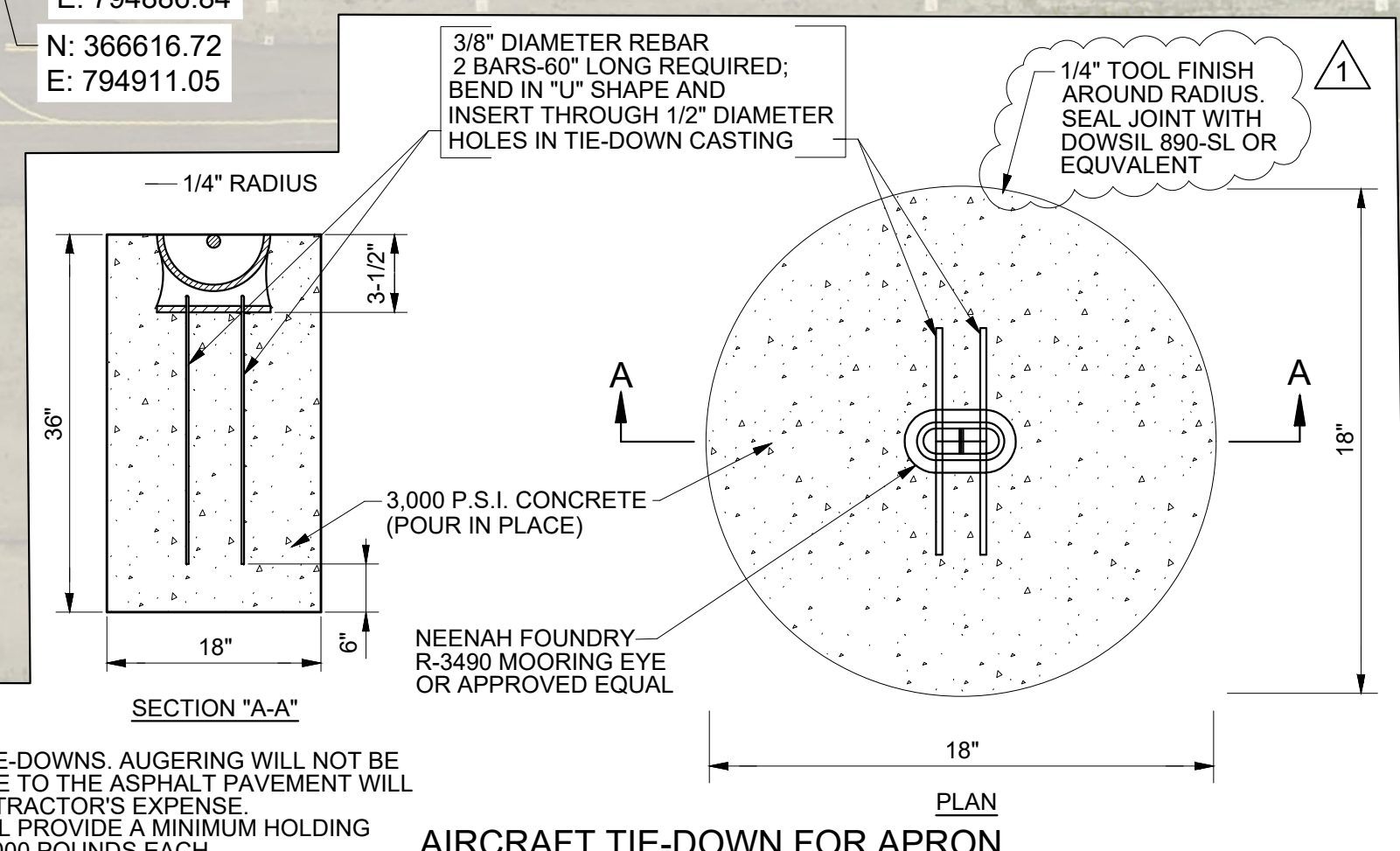
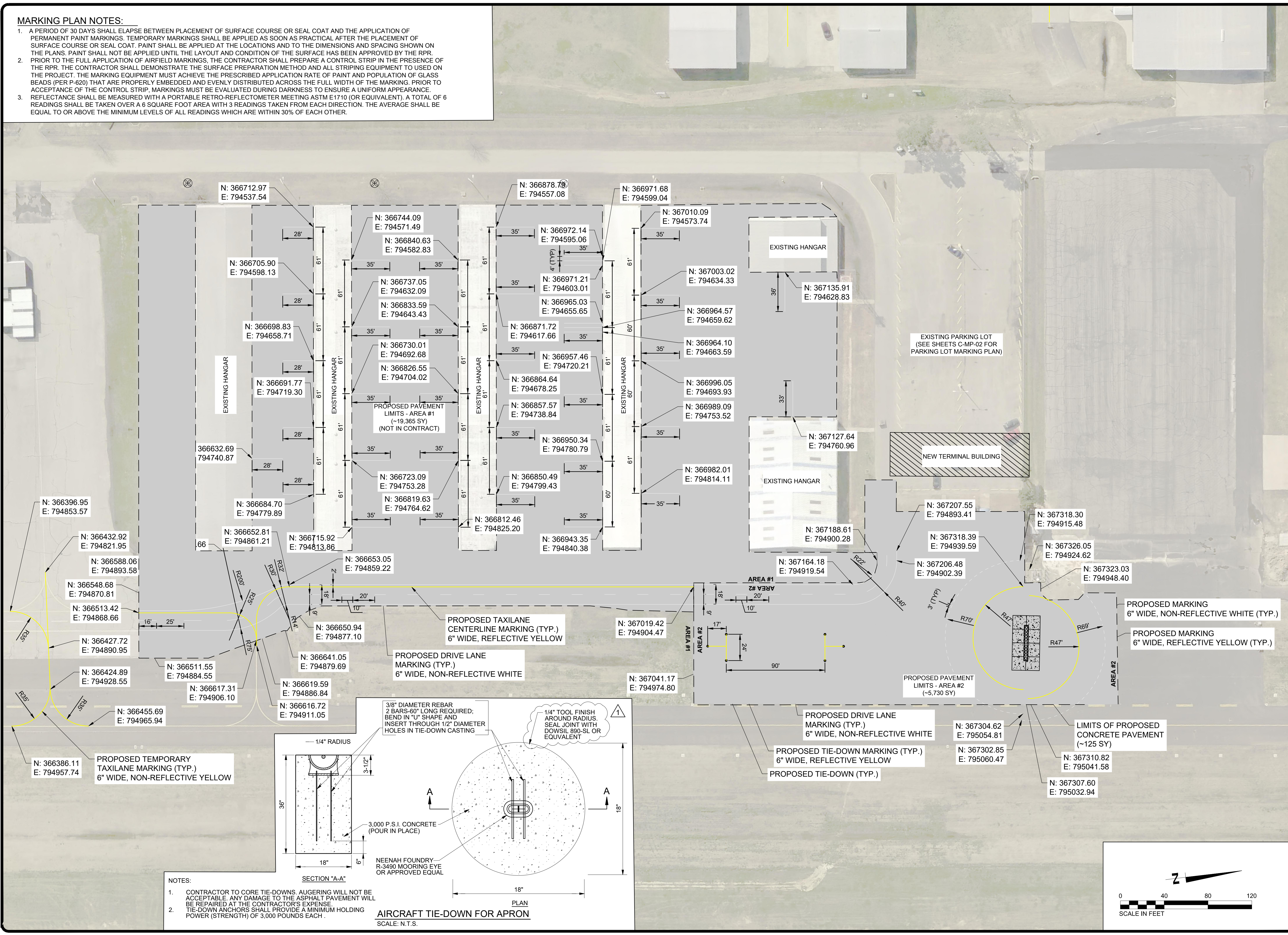

AIRCRAFT TIE-DOWN FOR APRON
SCALE: N.T.S.

- NOTES:**
1. CONTRACTOR TO CORE TIE-DOWNS. AUGERING WILL NOT BE ACCEPTABLE. ANY DAMAGE TO THE ASPHALT PAVEMENT WILL BE REPAIRED AT THE CONTRACTOR'S EXPENSE.
 2. TIE-DOWN ANCHORS SHALL PROVIDE A MINIMUM HOLDING POWER (STRENGTH) OF 3,000 POUNDS EACH.

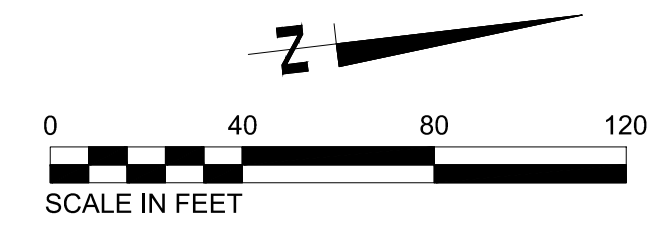

PROGRAM MANAGER

ENGINEER
BARGE
DESIGN SOLUTIONS, INC.
65 GERMANTOWN CT, SUITE 100
MEMPHIS, TN 38018

JOB NO. 33276-02

DRAWN BY: JEM
CHECKED BY: JAN
APPROVED BY: JEG

This information is released solely for its use in the interest of the Memphis-Shelby County Airport Authority (MSCAA) or its Tenants. All drawings received from MSCAA or produced for MSCAA as a work product shall be regarded as privileged information, not to be released to others without the express written permission of MSCAA. Your acceptance of the released materials establishes your understanding of, and commitment to, providing adequate control of the materials issued and produced.

REVISIONS

MARK	DATE	DESCRIPTION
	4/7/26	ISSUED FOR BID
Δ	4/28/26	ADDENDUM #1

MSCAA PROJ. NO. 18-1420-02-01

PROJECT: CHARLES BAKER
PAVEMENT IMPROVEMENTS
PHASE 2 - CONSTRUCTION

SHEET TITLE: AIRFIELD MARKING PLAN (AREAS 1 & 2)

DWG. FILE NAME: 3327602-81C-MP-01.DWG
DATE: 4/7/26
SCALE: 1"=40'

SHEET NO. C-MP-01
SHEET 20 OF 23

NOTES:

- DIMENSIONS ARE TO THE CENTERLINE OF WHITE MARKINGS, UNLESS OTHERWISE SHOWN.
- INTERIOR BLUE MARKINGS ARE SUPPLEMENTAL AND SHALL BE TINTED TO MATCH SHADE 15180 OF FEDERAL STANDARDS 595A.
- AN ACCESS AISLE IS REQUIRED FOR EACH ACCESSIBLE SPACE THAT IS NOT A PARALLEL PARKING SPACE.
- ACCESSIBLE AISLE TO BE LOCATED PASSENGER SIDE FOR SOLITARY ADA PARKING SPACE AND ALL VAN PARKING SPACES.
- PAVEMENT SYMBOL SHALL BE 3' OR 5' HIGH AND WHITE IN COLOR.
- IF NO CURBING IS SPECIFIED IN THE PLANS, WHEEL STOPS SHALL BE USED TO DELINEATE PARKING SPACES. SEE DETAILS.
- STALL DEPTH IS TO ACCOUNT FOR 2' VEHICLE OVERHANG AS MEASURED FROM FACE OF CURB OR FACE OF WHEEL STOP.

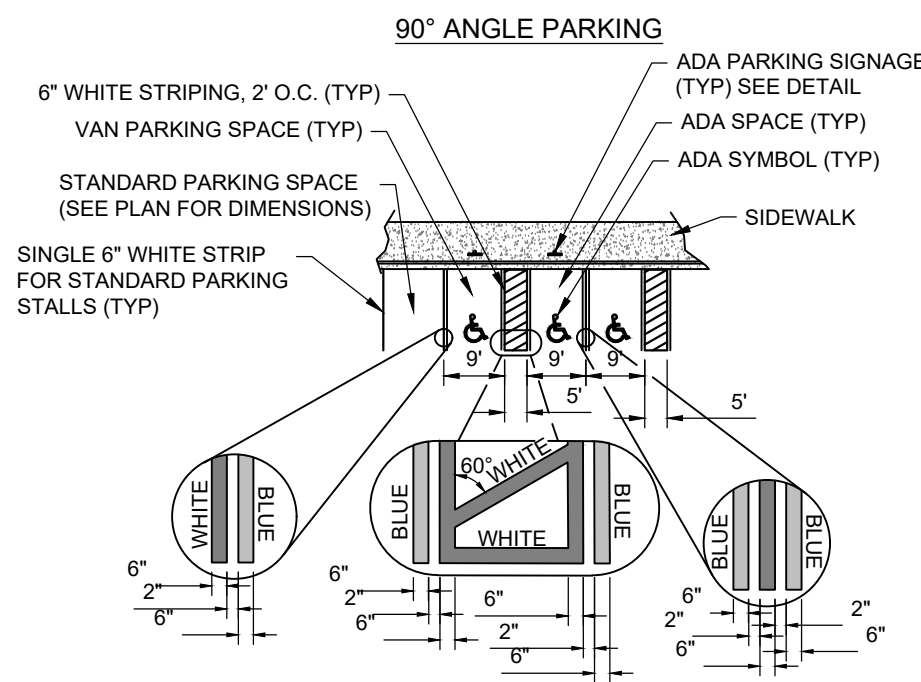

LOCATE ADA PARKING SIGNAGE EITHER:
 A. 2' FROM B.O.C.
 B. 2' FROM EDGE OF PAVEMENT IF NO CURB (FLUSH CONDITIONS)
 C. 2.5' FROM WHEEL STOP

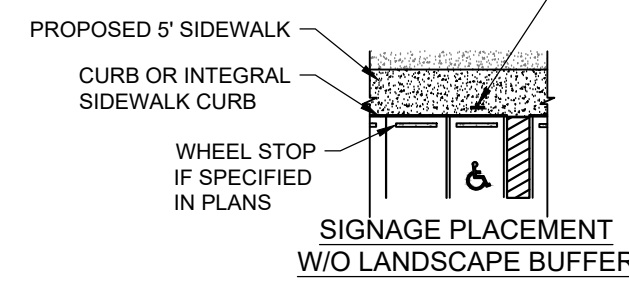
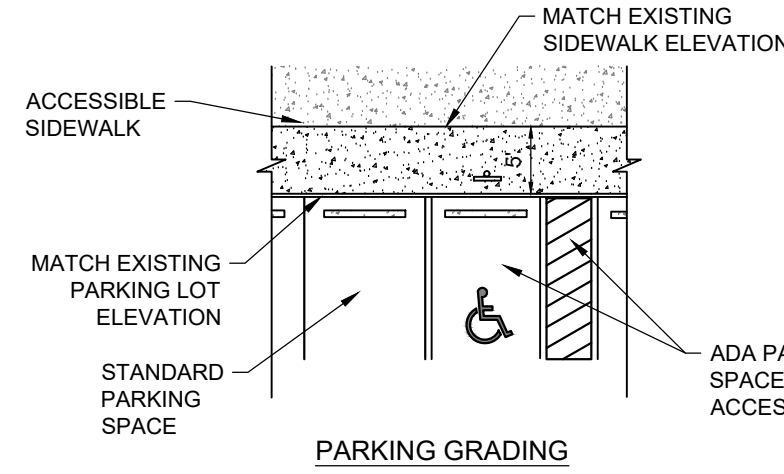

GRADING NOTES:

- ADA PARKING SPACES FINISHED GRADE SLOPES SHALL NOT EXCEED 1.5% IN ANY DIRECTION UNLESS OTHERWISE SPECIFIED IN PLANS.
- STANDARD ACCESSIBLE ROUTE CONSTRUCTION REQUIREMENTS ARE AS FOLLOWS UNLESS OTHERWISE NOTED:
 - MAX LONGITUDINAL SLOPE: 4.5%
 - STANDARD CROSS SLOPE: 1.5%
- STANDARD RAMP CONSTRUCTION REQUIREMENTS ARE AS FOLLOWS UNLESS OTHERWISE NOTED:
 - RAMP LENGTH: 7'
 - RAMP RISE: 6"
 - LANDING DEPTH: 5'
- STANDARD PARKING SPACES FINISHED GRADE SLOPES SHALL NOT EXCEED 4% UNLESS OTHERWISE SPECIFIED IN PLANS.

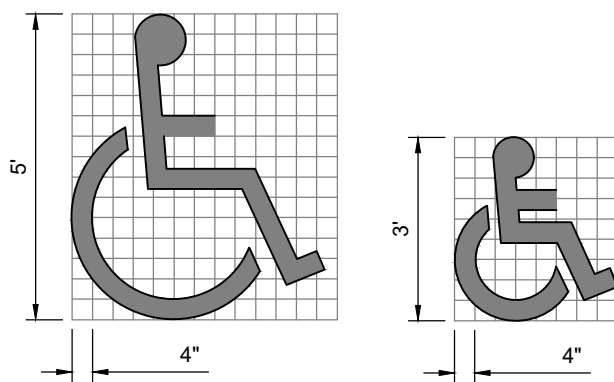

PAVEMENT MARKING SYMBOLS OF ACCESSIBILITY

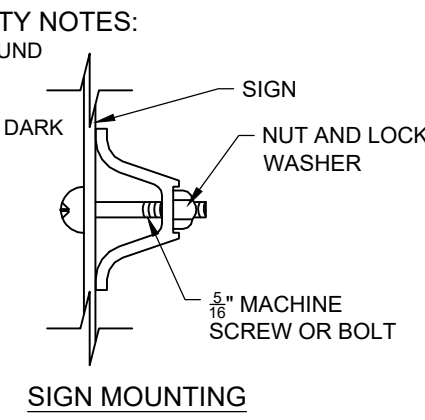
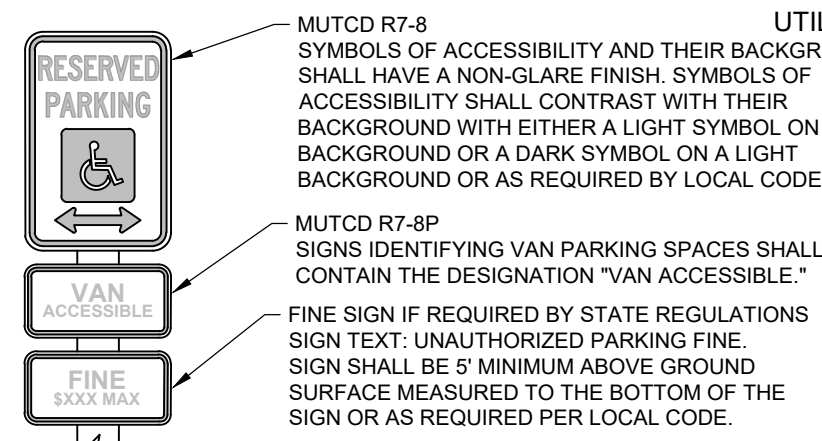

SIGN INFORMATION

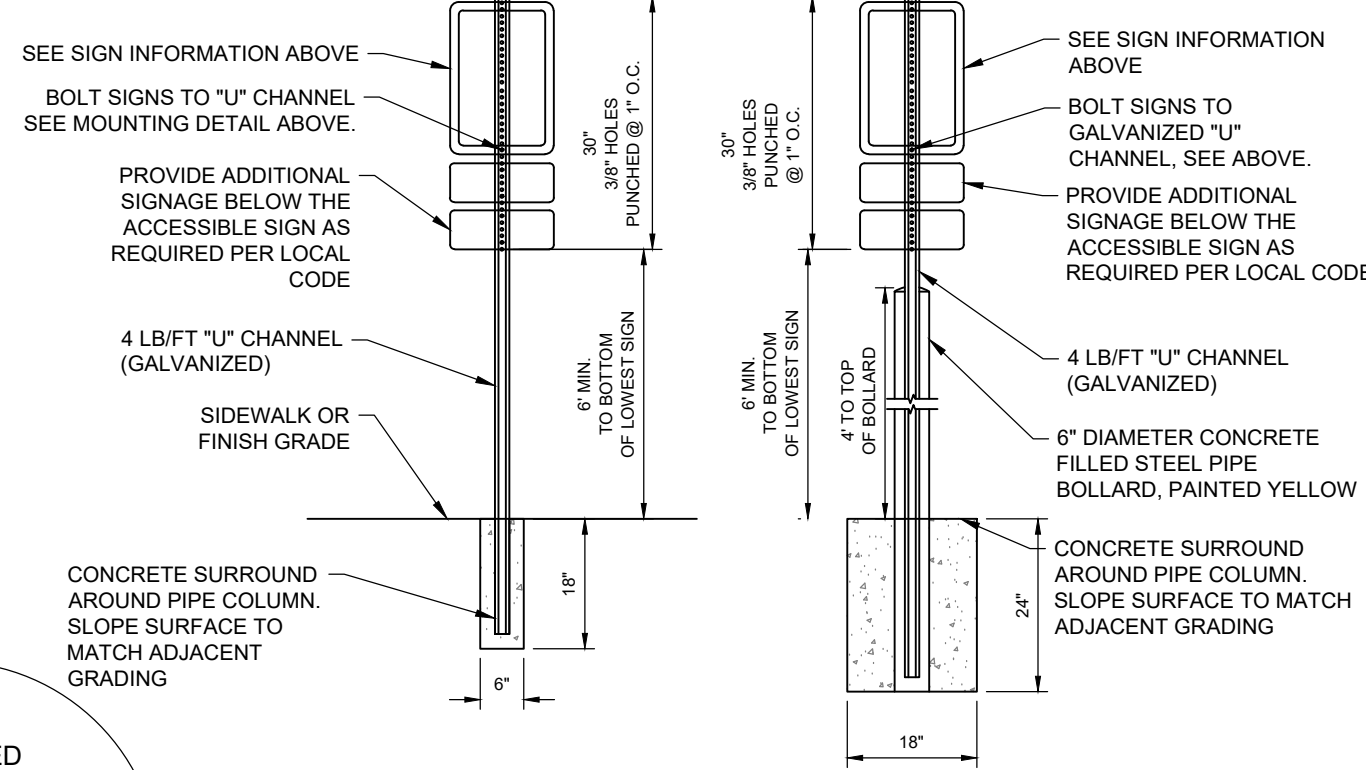

UNAUTHORIZED PARKING PUNISHABLE BY \$200 FINE AND SUBJECT TO TOWING BY (NAME/PHONE # OF TOWING CO.) OR (NAME/PHONE # OF PROPERTY OWNER, LESSEE, OR AGENT)

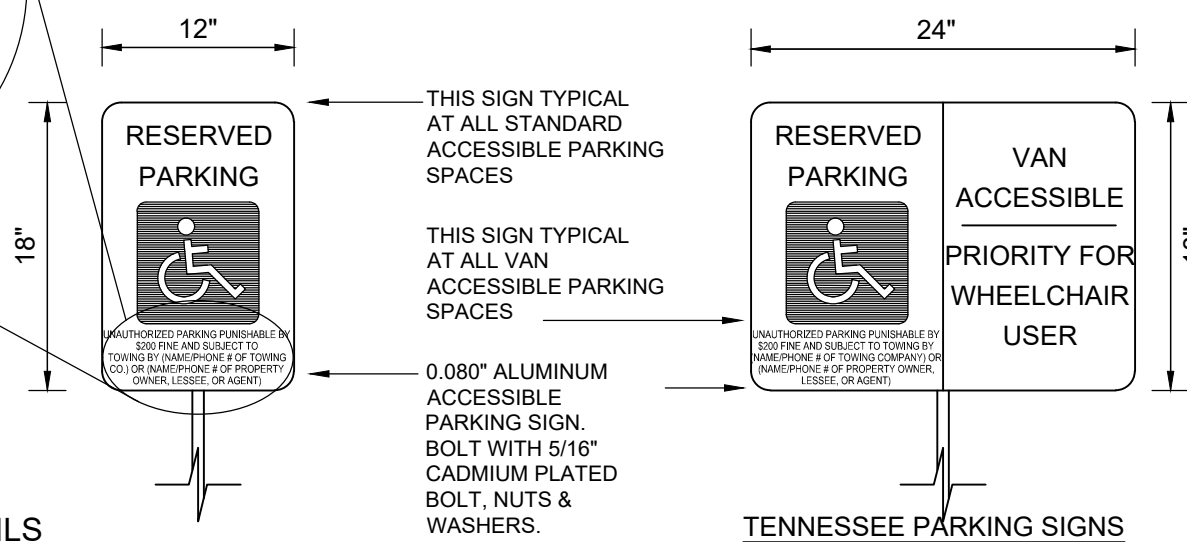

1 PARKING DETAILS
 C-MP-02 SCALE: NTS

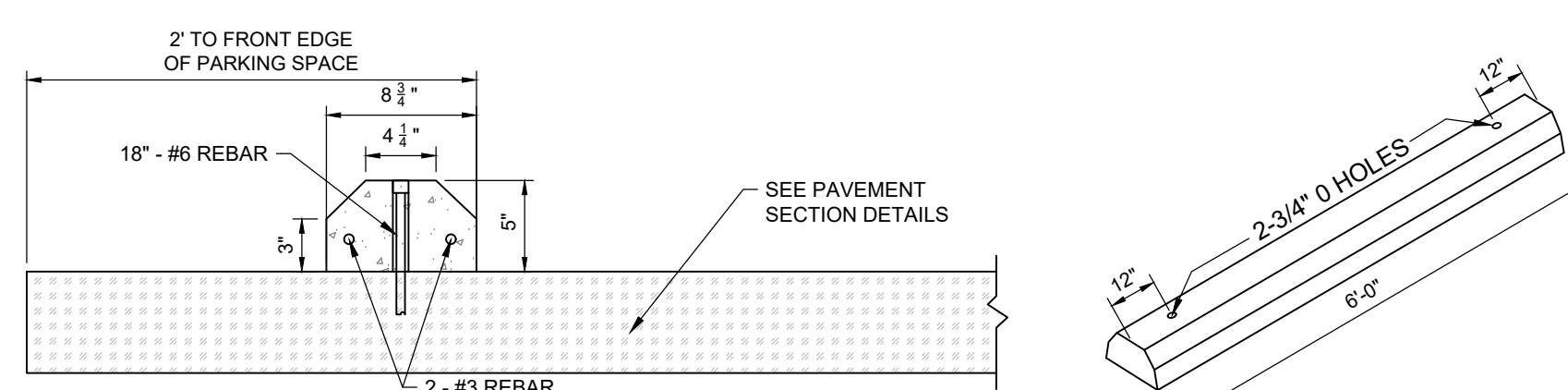

2 CONCRETE WHEELSTOP
 C-MP-02 SCALE: NTS

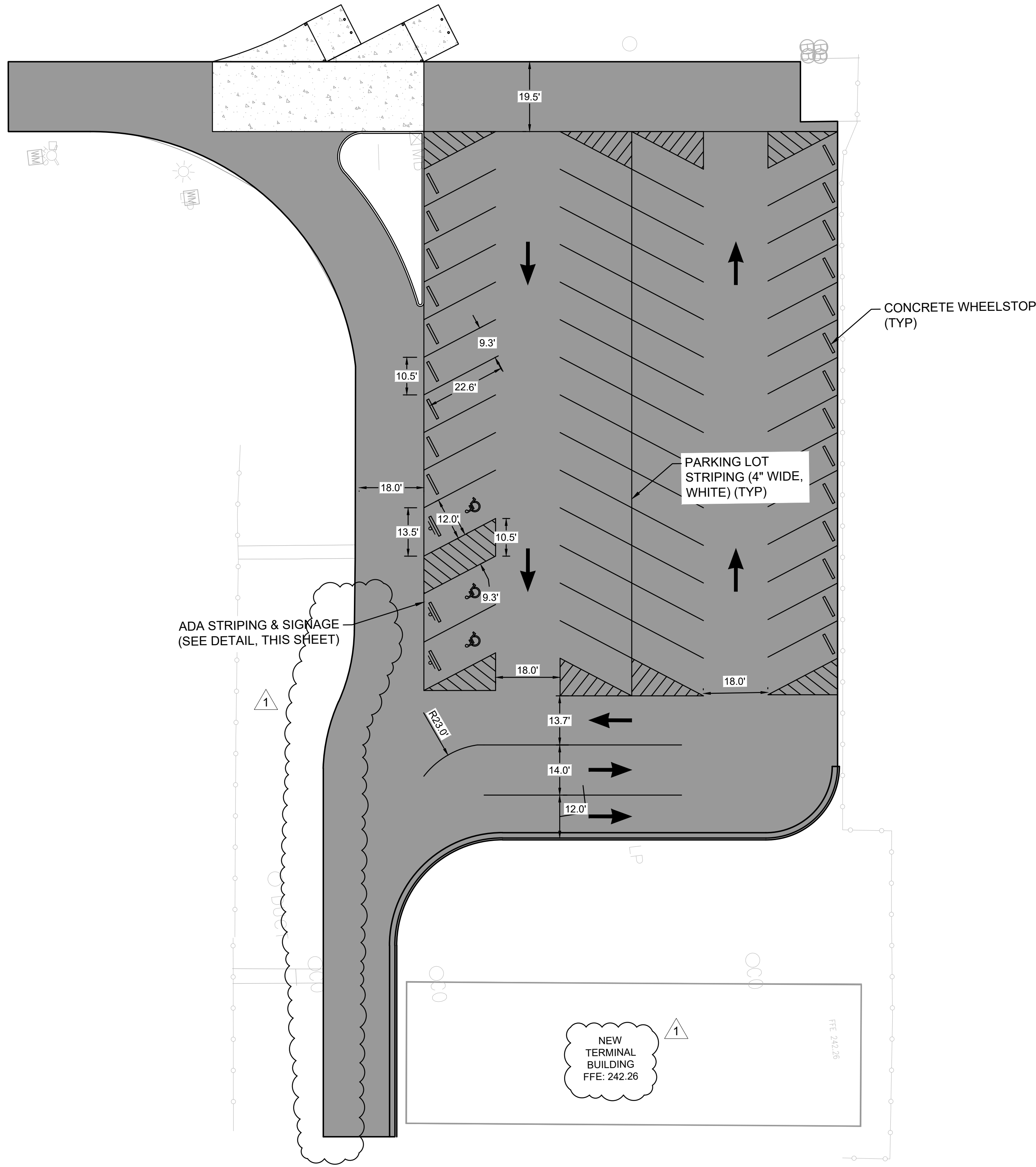

PROGRAM MANAGER

ENGINEER
BARGE
 DESIGN SOLUTIONS, INC.
 65 GERMANTOWN CT, SUITE 100
 MEMPHIS, TN 38018

JOB NO. 33276-02

DRAWN BY:

JEM

CHECKED BY:

JAN

APPROVED BY:

JEG



This information is released solely for its use in the interest of the Memphis-Shelby County Airport Authority (MSCAA) or its Tenants.
 All drawings received from MSCAA or produced for or produced for MSCAA as a work product shall be regarded as privileged information, not to be released to others without the express written permission of MSCAA.
 Your acceptance of the released materials establishes your understanding of, and commitment to, providing adequate control of the materials issued and produced.

REVISIONS

MARK	DATE	DESCRIPTION
	4/7/26	ISSUED FOR BID
1	4/28/26	ADDENDUM #1

MSCAA PROJ. NO.

18-1420-02-01

PROJECT:

**CHARLES BAKER
 PAVEMENT IMPROVEMENTS
 PHASE 2 - CONSTRUCTION**

SHEET TITLE:

**STRIPING PLAN
 (PARKING LOT)**

DWG. FILE NAME

3327602-81C-MP-02.DWG

DATE

4/7/26

SHEET NO.

C-MP-02

SCALE

1"=20'

SHEET

21 OF 23