



TAKE OFF WITH US

# Memphis

---

INTERNATIONAL AIRPORT

## Operations Report

April 16, 2026

# Service Spotlight

---

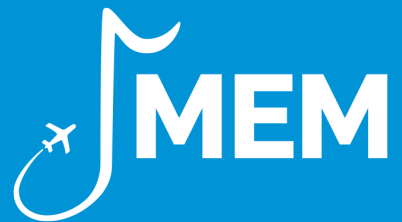

# Recognition

## Latina Suell - GAT

I left my purse on the plane and didn't realize until I was at baggage claims. I ran upstairs to the Spirit airline counter and explained to Latina, what I had done. **She had a smile on her face** and offered to go to plane and get it and **then meet me down at baggage claim to return it**. When she got to me with my purse, she was still smiling and repeated over and over how it was her pleasure to help me. She was the nicest, sweetest person I have come in contact within a long time. She is a gem to that airport and to Spirit Airlines. **I will make sure to stop and see her every time I fly out of Memphis** from now on. Latina at spirit, needs a HUGE raise!!!!

# Arts in the Airport

**19<sup>TH</sup> ANNUAL  
ARTS IN THE AIRPORT  
HIGH SCHOOL VISUAL ARTS  
AND PHOTOGRAPHY  
COMPETITION / EXHIBITION**

**THURSDAY, MAY 7, 2026  
5:30 - 7:30PM**

**A TICKETING  
AND MEZZANINE LEVELS**



# Communications

Happy National Public Safety  
Telecommunications Week to  
MEM's Airport Communications  
Team!!



# TSA Activity Recap

---





# MEM Weekly Checkpoint Throughput Comparison

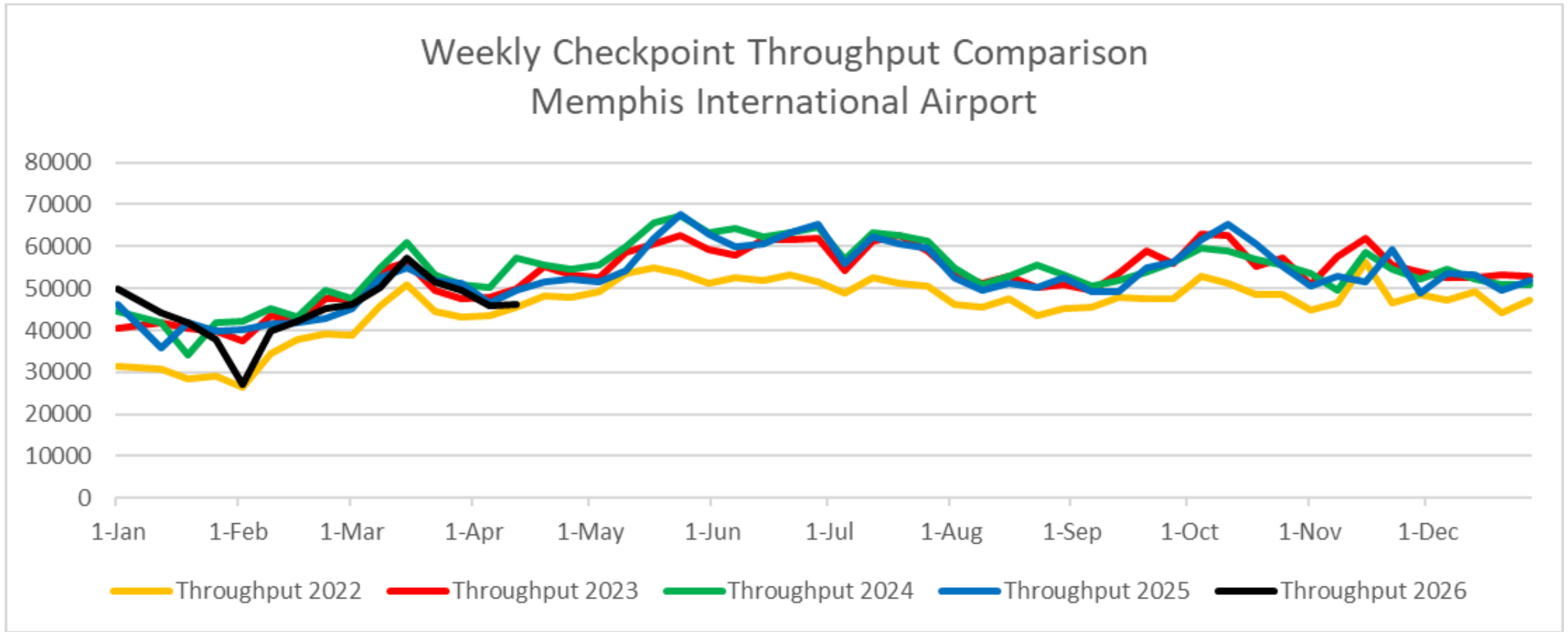



# Available Seats/Throughputs

## **Available Seats**

- April - 271,339 (+4.1% compared to 2025)
- May - 283,466 (-3.7% compared to 2025)

## **March Monthly Throughput**

- Total – 226,939
- Down 1.8% compared to March 2025

## **April Monthly Throughput (through April 14<sup>th</sup>)**

- Total – 95,500
- Down 1.2% compared to same period in April 2025

# Operations, Maintenance & Development

---



# Airside Operations

## New Quick Response Vehicle/Command Fire Truck "A1"



# Moving Walkway/Escalator Maintenance

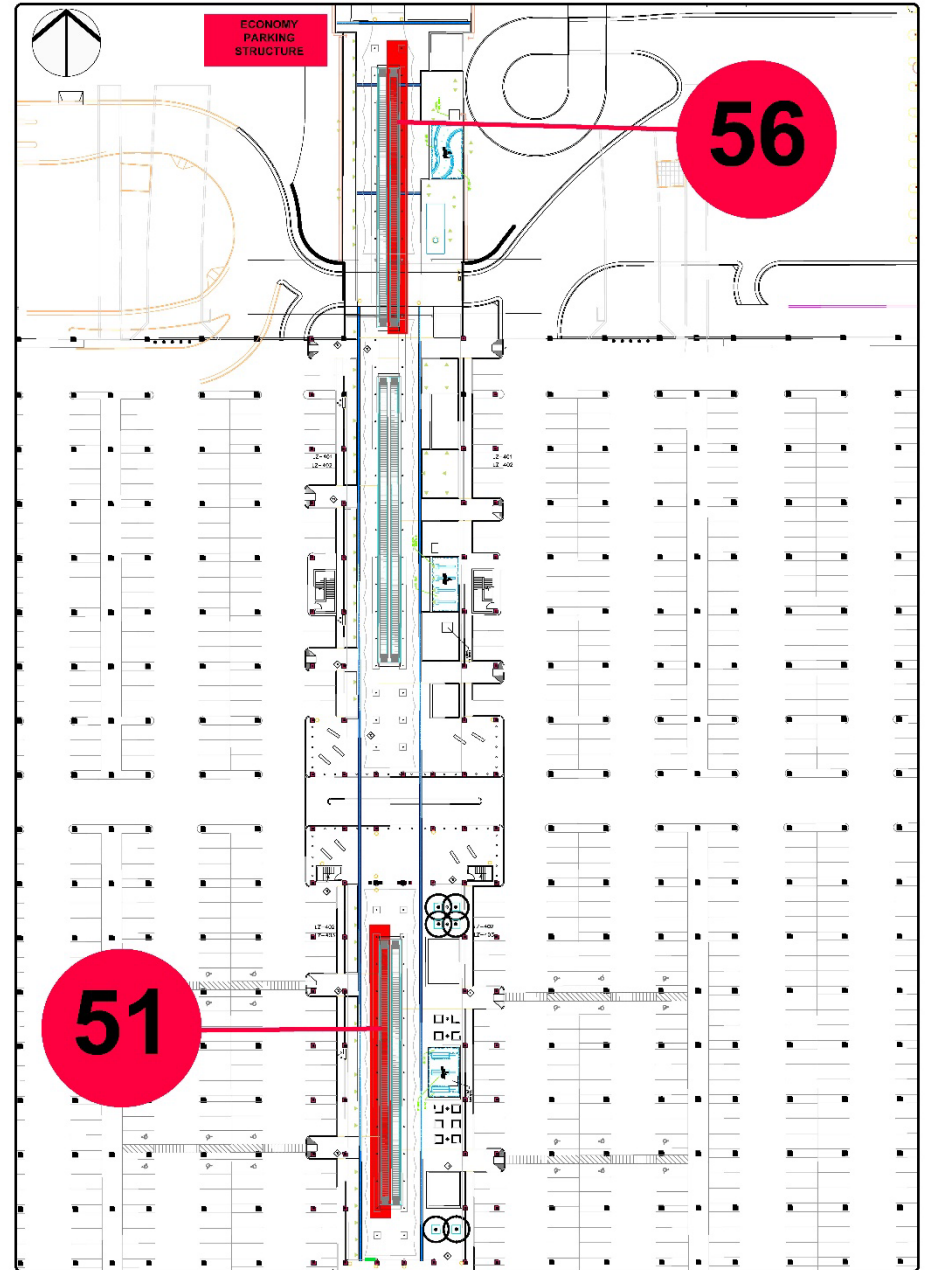
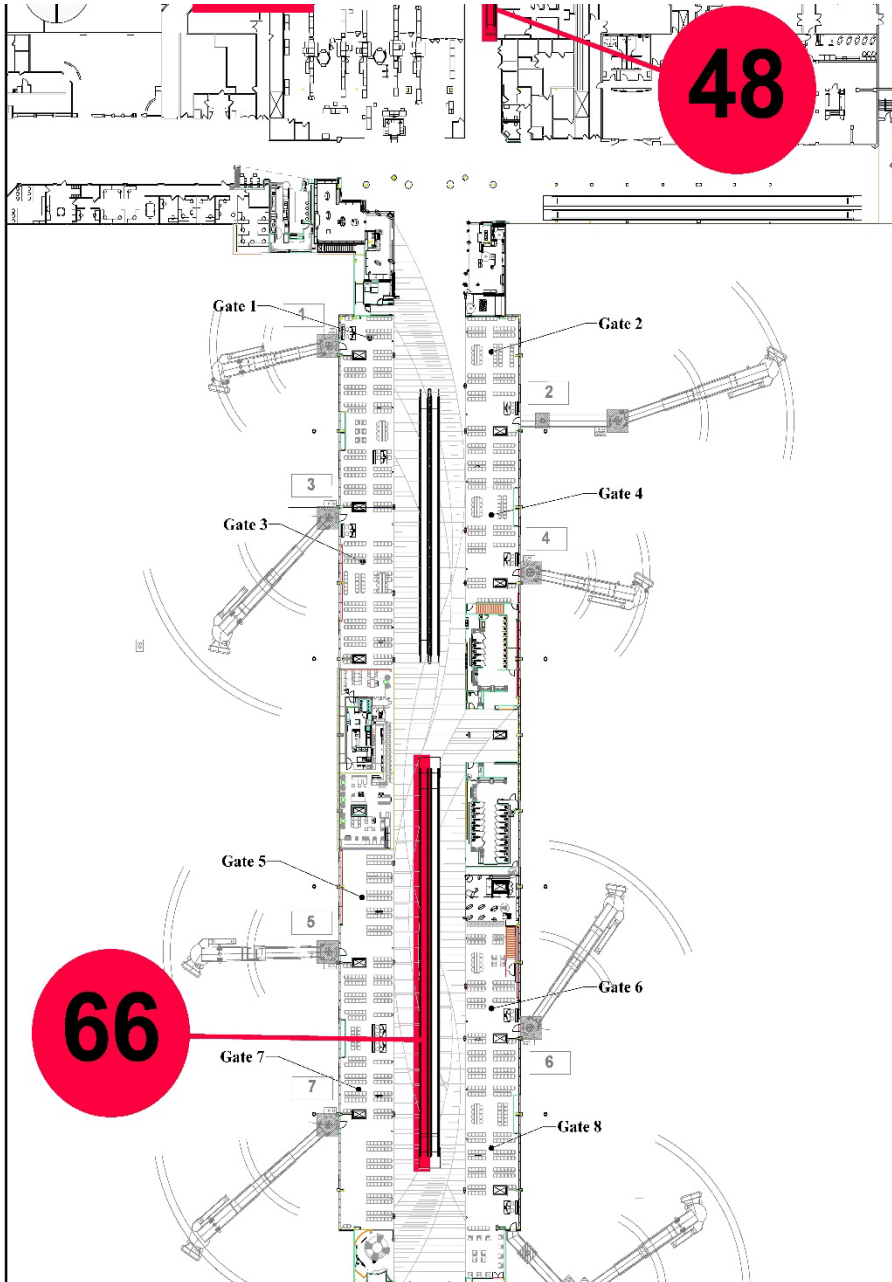

# Terminal Operations

Holidays at MEM - Easter Sunday  
- Candy and happy sayings



# TMSP – Outer Road – Demo/Replacement

- Outer Roadway Demolition preparation efforts started on September 10, 2025.
- Drilling has started for the new roadway structure.
- Terminal B Pedestrian Tunnel closed on 10/21/25. Work anticipated to be completed by 3/4/26. **UPDATE: Unforeseen conditions have pushed the tunnel opening date TBD.**

## ❖ OUTER ROADWAY IMPACTS:

- Terminal B Pedestrian Tunnel is closed. All pedestrian traffic routed to Terminal A and Terminal C.
- Coach Buses moved from upper/outer drive to upper/inner drive with staging area near Blue Lot.
- Lower/outer drive and lower/middle drive are closed.
- Annex and Vendor Lot access has been relocated
- Access to/from parking is being restricted to dedicated crosswalks.
- Commercial traffic was transitioned to the new location on September 9, 2025.

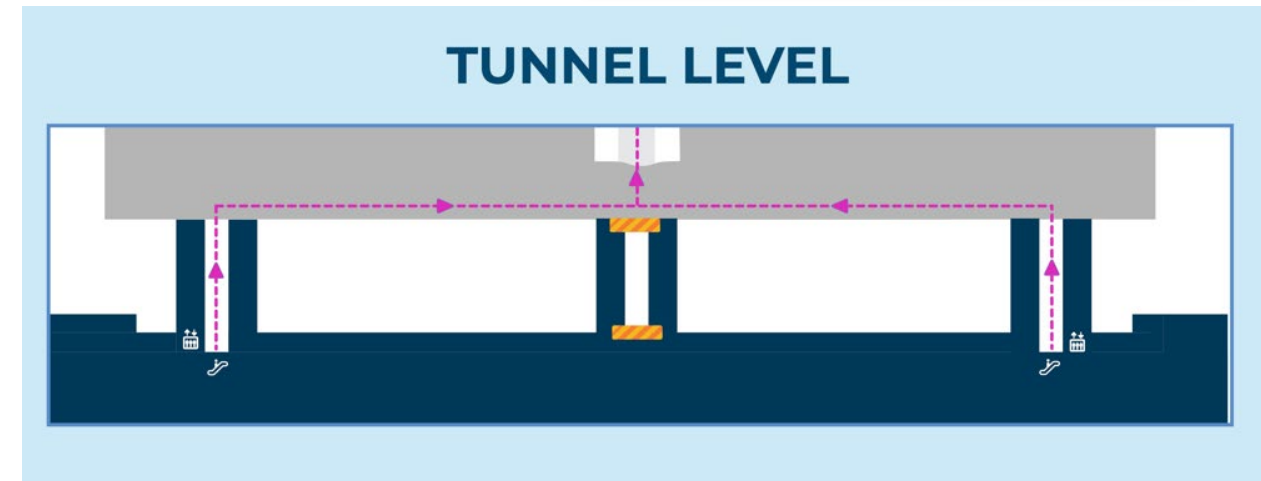

# TMSP – Concourse A Demolition

- New AOA/Perimeter Fence completed
  - Demolition work started July 8<sup>th</sup>.
  - Project will make way for new Administration Building and future CONRAC Facility
- ❖ **IMPACTS:**
- **RON Gates R09 to R16 Permanently Closed on 1/13/25**
  - **West Turnstile Closed on 5/5/25**
  - **Increased construction traffic on around the Concourse Vehicle Service Road**

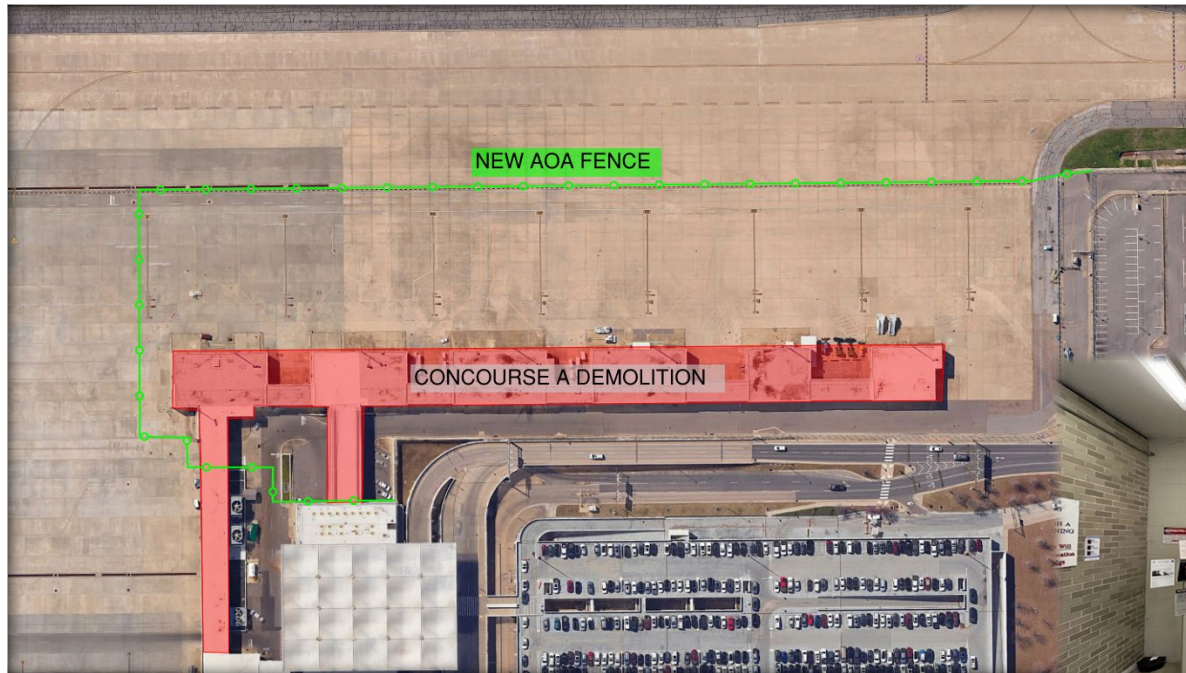

# Ongoing MEM Airside Projects

- **Runway 9/27 Status Lights**

- Contract Approved / Pre-Construction Activities
- Construction Start: Mid 2026
- Project Completion: Spring 2027

- **Airfield Popouts (Taxiway Yankee)**

- Finalizing Design & Phasing
- Construction Start: 2027/2028
- Working with FAA on timing

- **Snow Removal Equipment (SRE) Storage Building**

- Multi-Phase Project
- Phase 1 is a Site Preparation Package
  - Bids Received / April Board
  - Summer 2026 Construction
- Phase 2 is for the Storage Building (1<sup>st</sup> Phase)
  - May 2026 Bidding
  - Summer 2026 to Early 2027 Construction

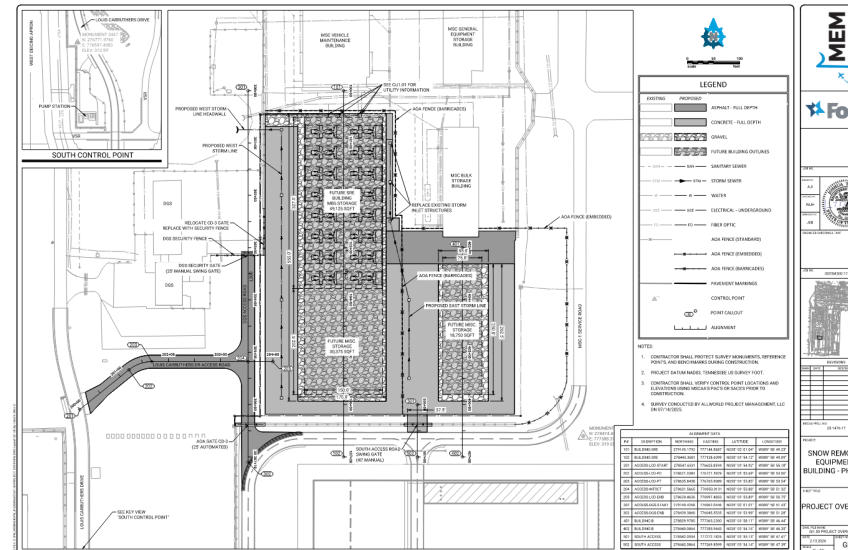
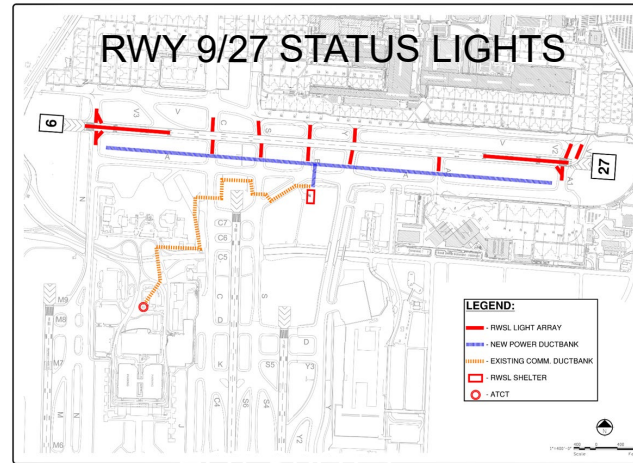

SRE BUILDING



# Ongoing MEM Landside Projects

- **Parking Information Signage**
  - Design complete December 2025
  - Bidding 1<sup>st</sup> Phase April/May 2026
- **Parking Guidance System (Economy & Short/Long Term Garages)**
  - Project Underway / Levels 5-7
  - Approx. 12-Month Construction Duration
  - Will require coordinated closures of parking areas within the garages
- **Rotunda Trash Chutes**
  - Construction Underway
  - Completion Delayed: April 2026
  - Training and Activation April/May 2026
- **CONRAC Facility/Garage**
  - Programming/Preliminary Design Underway
  - Final Design & Construction Timing TBD
- **East Parking Lot Expansion – Phase 5**
  - Advertised / Bids Due 5/7/26
  - Construction June – October 2026

EAST PARKING LOT

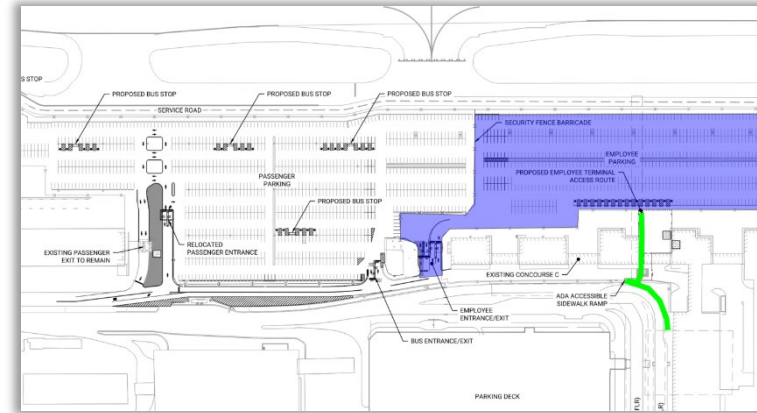

Memphis INTERNATIONAL AIRPORT	
Airport Parking Information	
Economy	Open
Short Term/Hourly	Open
Premium	Open
Blue Lot/Oversize	Full
Yellow Lot	Closed
Future Lot	

PARKING INFORMATION SIGNAGE







**TAKE OFF WITH US**

**JMEM**